

## Map of Statutory Natural Hazards For SAN BERNARDINO County

**Property Address:** 2760 N LINDEN AVE  
RIALTO, SAN BERNARDINO COUNTY, CA 92377  
("Property")

**APN:** 0239-341-13-0000  
**Report Date:** 10/14/2020  
**Report Number:** 2739237

### Map of Statutory Natural Hazard Zones

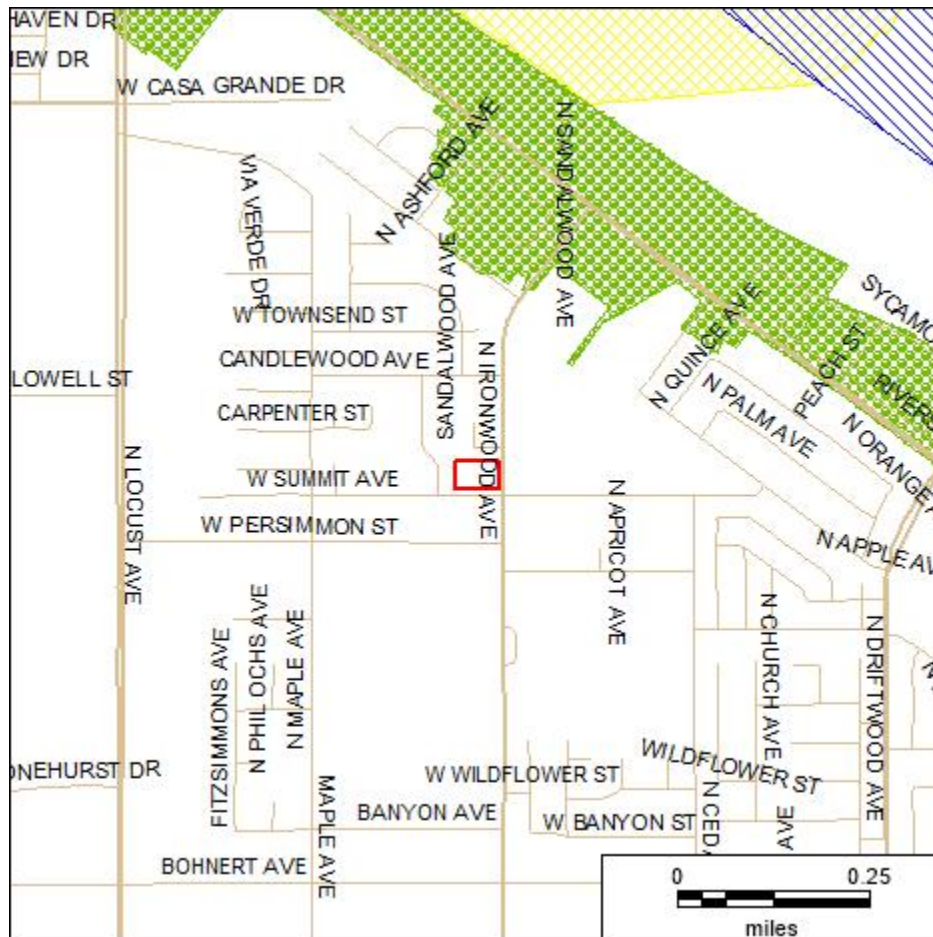

□ Subject Property

	Special Flood Hazard Area
	Area of Potential Flooding, Dam Failure
	Very High Fire Hazard Severity Zone
	Wildland Area, Substantial Forest Fire Risk
	Earthquake Fault Zone
	Seismic Hazard Zone, Landslide
	Seismic Hazard Zone, Liquefaction



**This map is provided for convenience only to show the approximate location of the Property and is not based on a field survey.**

**Natural Hazard Disclosure (NHD) Report  
For SAN BERNARDINO County**

**Property Address:** 2760 N LINDEN AVE  
RIALTO, SAN BERNARDINO COUNTY, CA 92377  
("Property")

**APN:** 0239-341-13-0000  
**Report Date:** 10/14/2020  
**Report Number:** 2739237

**Statutory Natural Hazard Disclosure ("NHD") Statement  
and Acknowledgment of Receipt**

The seller and seller's agent(s) or a third-party consultant disclose the following information with the knowledge that even though this is not a warranty, prospective buyers may rely on this information in deciding whether and on what terms to purchase the Property. Seller hereby authorizes any agent(s) representing any principal(s) in this action to provide a copy of this statement to any person or entity in connection with any actual or anticipated sale of the Property.

The following are representations made by the seller and seller's agent(s) based on their knowledge and maps drawn by the state and federal governments. This information is a disclosure and is not intended to be part of any contract between the seller and buyer. THIS REAL PROPERTY LIES WITHIN THE FOLLOWING HAZARDOUS AREA(S):

**A SPECIAL FLOOD HAZARD AREA** (Any type Zone "A" or "V") designated by the Federal Emergency Management Agency

Yes \_\_\_\_\_ No ☒ Do not know and information not available from local jurisdiction \_\_\_\_\_

**AN AREA OF POTENTIAL FLOODING** shown on a dam failure inundation map pursuant to Section 8589.5 of the Government Code.

Yes \_\_\_\_\_ No ☒ Do not know and information not available from local jurisdiction \_\_\_\_\_

**A VERY HIGH FIRE HAZARD SEVERITY ZONE** pursuant to Section 51178 or 51179 of the Government Code. The owner of this Property is subject to the maintenance requirements of Section 51182 of the Government Code.

Yes \_\_\_\_\_ No ☒

**A WILDLAND AREA THAT MAY CONTAIN SUBSTANTIAL FOREST FIRE RISKS AND HAZARDS** pursuant to Section 4125 of the Public Resources Code. The owner of this Property is subject to the maintenance requirements of Section 4291 of the Public Resources Code. Additionally, it is not the state's responsibility to provide fire protection services to any building or structure located within the wildlands unless the Department of Forestry and Fire Protection has entered into a cooperative agreement with a local agency for those purposes pursuant to Section 4142 of the Public Resources Code.

Yes \_\_\_\_\_ No ☒

**AN EARTHQUAKE FAULT ZONE** pursuant to Section 2622 of the Public Resources Code.

Yes \_\_\_\_\_ No ☒

**A SEISMIC HAZARD ZONE** pursuant to Section 2696 of the Public Resources Code.

Yes (Landslide Zone) \_\_\_\_\_ Yes (Liquefaction Zone) \_\_\_\_\_

No \_\_\_\_\_ Map not yet released by state ☒

THESE HAZARDS MAY LIMIT YOUR ABILITY TO DEVELOP THE REAL PROPERTY, TO OBTAIN INSURANCE, OR TO RECEIVE ASSISTANCE AFTER A DISASTER. THE MAPS ON WHICH THESE DISCLOSURES ARE BASED ESTIMATE WHERE NATURAL HAZARDS EXIST. THEY ARE NOT DEFINITIVE INDICATORS OF WHETHER OR NOT A PROPERTY WILL BE AFFECTED BY A NATURAL DISASTER. SELLER(S) AND BUYER(S) MAY WISH TO OBTAIN PROFESSIONAL ADVICE REGARDING THOSE HAZARDS AND OTHER HAZARDS THAT MAY AFFECT THE PROPERTY.

Signature of Seller(s) \_\_\_\_\_ Date \_\_\_\_\_ Signature of Seller(s) \_\_\_\_\_ Date \_\_\_\_\_

Signature of Seller's Agent \_\_\_\_\_ Date \_\_\_\_\_ Signature of Seller's Agent \_\_\_\_\_ Date \_\_\_\_\_

☐ Seller(s) and their agent(s) represent that the information herein is true and correct to the best of their knowledge as of the date signed by the transferor(s) and agent(s).

☒ Seller(s) and their agent(s) acknowledge that they have exercised good faith in the selection of a third-party report provider as required in Section 1103.7 of the Civil Code, and that the representations made in this Natural Hazard Disclosure Statement are based upon information provided by the independent third-party disclosure provider as a substituted disclosure pursuant to Section 1103.4 of the Civil Code. Neither seller(s) nor their agent(s) (1) has independently verified the information contained in this statement and Report or (2) is personally aware of any errors or inaccuracies in the information contained on the statement. This statement was prepared by the provider below:

Third-Party Disclosure Provider(s) FIRST AMERICAN PROFESSIONAL REAL ESTATE SERVICES, INC. OPERATING THROUGH ITS JCP-LGS DIVISION.  
Date 14 October 2020

Buyer represents that he or she has read and understands this document. Pursuant to Civil Code Section 1103.8, the representations made in this Natural Hazard Disclosure Statement do not constitute all of the seller(s) or agent's disclosure obligations in this transaction.

Signature of Buyer(s) \_\_\_\_\_ Date \_\_\_\_\_ Signature of Buyer(s) \_\_\_\_\_ Date \_\_\_\_\_

**BUYER(S) REPRESENTS ABOVE HE/SHE HAS RECEIVED, READ AND UNDERSTANDS THE COMPLETE JCP-LGS DISCLOSURE REPORT DELIVERED WITH THIS SUMMARY:**

- Additional Property-specific Statutory Disclosures: Former Military Ordnance Site, Commercial/Industrial Use Zone, Airport Influence Area, Airport Noise, San Francisco Bay Conservation and Development District Jurisdiction (in S.F. Bay counties only), California Energy Commission Duct Sealing Requirement, Notice of Statewide Right to Farm, Notice of Mining Operations, Sex Offender Database (Megan's Law), Gas and Hazardous Liquid Transmission Pipeline Database.
- Additional County and City Regulatory Determinations as applicable: Airports, Avalanche, Blow Sand, Coastal Zone, Dam/Levee Failure Inundation, Debris Flow, Erosion, Flood, Fault Zone, Fire, Groundwater, Landslide, Liquefaction, Methane Gas, Mines, Naturally Occurring Asbestos, Redevelopment Area, Right to Farm, Runoff Area, Seiche, Seismic Shaking, Seismic Ground Failure, Slope Stability, Soil Stability, Subsidence, TRPA, Tsunami.
- General advisories: Methamphetamine Contamination, Mold, Radon, Endangered Species Act, Abandoned Mines, Oil & Gas Wells, Tsunami Maps (coastal only).
- Additional Reports - Enclosed if ordered: (1) PROPERTY TAX REPORT (includes state-required Notices of Mello-Ross and 1915 Bond Act Assessments, and Notice of Supplemental Property Tax Bill, (2) ENVIRONMENTAL SCREENING REPORT (discloses Transmission Pipelines, Contaminated Sites, and Oil & Gas Wells). Enclosed if applicable: Local Addenda.
- Government Guides in Combined Booklet with Report. Refer to Booklet: (1) ENVIRONMENTAL HAZARDS: "A Guide for Homeowners, Buyers, Landlords and Tenants"; (2) EARTHQUAKE SAFETY: "The Homeowners Guide To Earthquake Safety" and included "RESIDENTIAL EARTHQUAKE HAZARDS REPORT FORM"; (3) LEAD-BASED PAINT: "Protect Your Family From Lead In Your Home"; (4) BRIEF GUIDE TO MOLD, MOISTURE AND YOUR HOME; (5) WHAT IS YOUR HOME ENERGY RATING? Government Guides are also available on the Company's "Electronic Bookshelf" at <http://www.disclosures.com/>.

**Contents**  
**For SAN BERNARDINO County**

**Property Address:** 2760 N LINDEN AVE  
RIALTO, SAN BERNARDINO COUNTY, CA 92377  
("Property")

**APN:** 0239-341-13-0000  
**Report Date:** 10/14/2020  
**Report Number:** 2739237

**Table of Contents**

Map of Statutory Natural Hazards.....	<a href="#">1</a>
Statutory NHD Statement and Acknowledgment of Receipt.....	<a href="#">2</a>
Table of Contents.....	<a href="#">3</a>
Summary of Disclosure Determinations.....	<a href="#">4-5</a>
NHD Report.....	<a href="#">6-24</a>
Tax Report.....	<a href="#">25-32</a>
Terms and Conditions.....	<a href="#">33-37</a>

# JCP-LGS Residential Resale Property Disclosure Reports

## Summary of Disclosure Determinations

### For SAN BERNARDINO County

**Property Address:** 2760 N LINDEN AVE  
 RIALTO, SAN BERNARDINO COUNTY, CA 92377  
 ("Property")

**APN:** 0239-341-13-0000  
**Report Date:** 10/14/2020  
**Report Number:** 2739237

### PROPERTY DISCLOSURE SUMMARY - READ FULL REPORT

Statutory NHD Determinations	IN	NOT IN	Map N/A*	Property is:	NHD Report page:
Flood		<b>X</b>		NOT IN a Special Flood Hazard Area. The Property is IN a FEMA-designated Flood Zone(s) X.	<a href="#">6</a>
Dam		<b>X</b>		NOT IN an area of potential dam inundation.	<a href="#">6</a>
Very High Fire Hazard Severity		<b>X</b>		NOT IN a very high fire hazard severity zone.	<a href="#">7</a>
Wildland Fire Area		<b>X</b>		Not in a wildland-state responsibility area.	<a href="#">7</a>
Fault		<b>X</b>		NOT IN an earthquake fault zone designated pursuant to the Alquist-Priolo Act.	<a href="#">8</a>
Landslide			<b>X</b>	Map Not Available	<a href="#">8</a>
Liquefaction			<b>X</b>	Map Not Available	<a href="#">8</a>

County-level NHD Determinations	IN	NOT IN	Map N/A*	Property is:	NHD Report page:
Liquefaction		<b>X</b>		NOT IN an area of liquefaction susceptibility	<a href="#">10</a>
Fault		<b>X</b>		NOT WITHIN a designated or adopted fault zone.	<a href="#">10</a>
Landslide		<b>X</b>		NOT IN a mapped Landslide	<a href="#">10</a>
Fire		<b>X</b>		NOT IN a designated Fire Safety Area.	<a href="#">10</a>
Flood			<b>X</b>	Map Not Available	<a href="#">11</a>
Landslide Susceptibility	<b>X</b>			IN a mapped area of low landslide susceptibility.	<a href="#">10</a>

City-level NHD Determinations	IN	NOT IN	Map N/A*	Property is:	NHD Report page:
Fault		<b>X</b>		NOT WITHIN 660 feet of a mapped Fault Trace , Groundwater Barrier, or Lineament that is not bounded by a regulatory zone.	<a href="#">12</a>

Additional Statutory Disclosures	IN	NOT IN	Map N/A*	Property is:	NHD Report page:
Former Military Ordnance	<b>X</b>			WITHIN one mile of a formerly used ordnance site.: Rialto Ammunition Storage Point	<a href="#">13</a>
Commercial or Industrial	<b>X</b>			WITHIN one mile of a property zoned to allow commercial or industrial use.	<a href="#">13</a>
Airport Influence Area	<b>X</b>			IN an airport influence area: Rialto Municipal Airport	<a href="#">14</a>
Airport Noise Area for 65 Decibel		<b>X</b>		NOT IN a delineated 65 dB CNEL or greater aviation noise zone.	<a href="#">15</a>
California Energy Commission	<b>X</b>			IN a climate zone where properties are usually subject to duct sealing and testing requirements	<a href="#">16</a>
Right to Farm Act	<b>X</b>			IN a one mile radius of designated Important Farmland that requires a statutory "Notice of Right to Farm" be provided in this Report.	<a href="#">17</a>
Notice of Mining Operations		<b>X</b>		NOT IN a one mile radius of a mapped mining operation that requires a statutory "Notice of Mining Operation" be provided in this Report:	<a href="#">18</a>

General Advisories	Description	NHD Report page:
Registered Sex Offender Data Base (Megan's Law) Notice	Provides an advisory required pursuant to Section 290.46 of the Penal Code. Information about specified registered sex offenders is made available to the public.	<a href="#">19</a>
Gas and Hazardous Liquid Transmission Pipeline Database Notice	Provides a notice required pursuant to Section 2079.10.5(a) of the Civil Code. Information about transmission pipeline location maps is made available to the public.	<a href="#">20</a>

# JCP-LGS Residential Resale Property Disclosure Reports

## Summary of Disclosure Determinations

### For SAN BERNARDINO County

**Property Address:** 2760 N LINDEN AVE  
RIALTO, SAN BERNARDINO COUNTY, CA 92377  
("Property")

**APN:** 0239-341-13-0000  
**Report Date:** 10/14/2020  
**Report Number:** 2739237

General Advisories	Description	NHD Report page:
Methamphetamine Contamination	Provides an advisory that a disclosure may be required pursuant to the "Methamphetamine Contaminated Property Cleanup Act of 2005".	<a href="#">21</a>
Mold	Provides an advisory that all prospective purchasers of residential and commercial property should thoroughly inspect the subject property for mold and sources for additional information on the origins of and the damage caused by mold.	<a href="#">22</a>
Radon	Provides an advisory on the risk associated with Radon gas concentrations.	<a href="#">23</a>
Endangered Species	Provides an advisory on resources to educate the public on locales of endangered or threatened species.	<a href="#">23</a>
Abandoned Mines	Provides an advisory on resources to educate the public on the hazards posed by, and some of the general locales of, abandoned mines.	<a href="#">24</a>
Oil and Gas Wells	Provides an advisory on the potential existence of oil and gas wells and sources for additional general and/or specific information.	<a href="#">24</a>

Property Tax Determinations	IS	IS NOT	Property is:	Tax Report page:
Mello-Roos Districts		<b>X</b>	NOT SUBJECT TO a Mello-Roos Community Facilities District.	<a href="#">26</a>
1915 Bond Act Districts		<b>X</b>	NOT SUBJECT TO a 1915 Bond Act District.	<a href="#">26</a>
PACE Contract Assessment		<b>X</b>	NOT SUBJECT TO a Property Assessed Clean Energy (PACE) Contract.	<a href="#">26</a>
Other Direct Assessments	<b>X</b>		SUBJECT TO one or more other direct assessments.	<a href="#">28</a>
SRA Fire Prevention Fee		<b>X</b>	NOT SUBJECT TO the State Responsibility Area Fire Prevention Fee (SRA Fee is suspended until 2031 by Assembly Bill 398 of 2017).	<a href="#">32</a>

Determined by First American Professional Real Estate Services, Inc.

For more detailed information as to the foregoing determinations, please read this entire Report.

**Natural Hazard Disclosure (NHD) Report  
For SAN BERNARDINO County**

**Property Address:** 2760 N LINDEN AVE  
RIALTO, SAN BERNARDINO COUNTY, CA 92377  
("Property")

**APN:** 0239-341-13-0000  
**Report Date:** 10/14/2020  
**Report Number:** 2739237

## Natural Hazard Disclosure Report

### Part 1. State Defined Natural Hazard Zones

#### Statutory Natural Hazard Disclosures

Section 1103 of the California Civil Code mandates the disclosure of six (6) natural hazard zones if the Property is located within any such zone. Those six "statutory" hazard zones, disclosed on the **Natural Hazard Disclosure Statement** ("NHDS") on Page one of this Report, are explained below. Note that the NHDS does not provide for informing buyers if a property is only partially within any of the delineated zones or provide additional flood zone information which could be very important to the process. The following summary is intended to give buyers additional information they may need to help them in the decision-making process and to place the information in perspective.

#### SPECIAL FLOOD HAZARD AREA

**DISCUSSION:** Property in a Special Flood Hazard Area (any type of Zone "A" or "V" as designated by the Federal Emergency Management Agency ("FEMA")) is subject to flooding in a "100-year rainstorm." Federally connected lenders require homeowners to maintain flood insurance for buildings in these zones. A 100-year flood occurs on average once every 100 years, but may not occur in 1,000 years or may occur in successive years. According to FEMA, a home located within a SFHA has a 26% chance of suffering flood damage during the term of a 30-year mortgage. Other types of flooding, such as dam failure, are not considered in developing these zones. Flood insurance for properties in Zones B, C, D, X, X500, and X500\_Levee is available but is not required.

**Zones A, AO, AE, AH, AR, A1-A30:** Area of "100-year" flooding - a 1% or greater chance of annual flooding.

**Zone A99:** An "adequate progress" determination for flood control system construction projects that, once completed, may significantly limit the area of a community that will be included in the Special Flood Hazard Area (SFHA). Such projects reduce but do not eliminate, the risk of flooding to people and structures in "levee-impacted" areas, and allow mandatory flood insurance to be available at a lower cost.

**Zones V, V1-V30:** Area of "100-year" flooding in coastal (shore front) areas subject to wave action.

**Zone B:** Area of moderate flood risk. These are areas between the "100" and "500" year flood-risk levels.

**Zones C, D:** NOT IN an area of "100-year" flooding. Area of minimal (Zone C) or undetermined (Zone D) flood hazard.

**Zones X:** An area of minimal flood risk. These are areas outside the "500" year flood-risk level.

**Zone X500:** An area of moderate flood risk. These are areas between the "100" and "500" year flood-risk levels.

**Zone X500\_LEVEE:** An area of moderate flood risk that is protected from "100-year flood" by levee and that is subject to revision to high risk (Zone A) if levee is decertified by FEMA.

**Zone N:** Area Not Included, no flood zone designation has been assigned or not participating in the National Flood Insurance Program.

**Notice:** The Company is not always able to determine if the Property is subject to a FEMA Letter of Map Revision ("LOMR") or other FEMA letters of map change. If Seller is aware that the Property is subject to a LOMR or other letters of map change, the Seller shall disclose the map change and attach a copy of the FEMA letter(s) to the Report. Contact FEMA at <http://msc.fema.gov> for additional information.

For more information about flood zones, visit:

[https://efotg.sc.egov.usda.gov/references/public/NM/FEMA\\_FLD\\_HAZ\\_guide.pdf](https://efotg.sc.egov.usda.gov/references/public/NM/FEMA_FLD_HAZ_guide.pdf)

**PUBLIC RECORD:** Official Flood Insurance Rate Maps ("FIRM") compiled and issued by the Federal Emergency Management Agency ("FEMA") pursuant to 42 United States Code §4001, et seq.

#### AREA OF POTENTIAL FLOODING (DAM FAILURE)

Since 1998 California law has required seller disclosure of areas of potential inundation due to sudden or total dam failure as delineated on inundation maps submitted by dam owners to the California Office of Emergency Services ("OES") for review and approval; however, as of June 27, 2017, the date on which Senate Bill 92 (SB 92) became operative, the review and approval of inundation maps prepared by licensed civil engineers and submitted by dam owners became the statutory responsibility of the California Department of Water Resources ("DWR") Division of Safety of Dams ("DSOD") as required by California Water Code Section 6161. These inundation maps are a component of emergency action plans submitted by dam owners to comply with statutory requirements set forth under the California Water Code for extremely high, high, and significant hazard dams and their critical appurtenant structures. Inundation maps are not required by the California Water Code for low hazard dams. SB 92 further requires dam owners to update the emergency action plan, including an inundation map, no less frequently than every 10 years or sooner.



**Natural Hazard Disclosure (NHD) Report  
For SAN BERNARDINO County**

**Property Address:** 2760 N LINDEN AVE  
RIALTO, SAN BERNARDINO COUNTY, CA 92377  
("Property")

**APN:** 0239-341-13-0000  
**Report Date:** 10/14/2020  
**Report Number:** 2739237

To date DWR has yet to review, approve, and make publicly available inundation maps and data for many facilities with inundation areas that are subject to disclosure requirements. Inundation maps will continue to be posted and updated maps will replace outdated maps as they are approved by DSOD. In the absence of DSOD-approved data, inundation maps previously approved by the OES will be used by the Company to facilitate compliance with specified statutory real estate transfer disclosure requirements. These include inundation maps for federally owned dams over which DSOD has no jurisdictional authority and for which inundation maps are not available from DSOD. These dams include, among others, Folsom Dam, Isabella Dam, Hansen Dam, Prado Dam, and Seven Oaks Reservoir (owned by the U.S. Army Corps of Engineers) as well as Monticello Dam, New Melones Dam, and Shasta Dam (owned by the U.S. Bureau of Reclamation). The Company may also use OES-approved maps should the mapped inundation area for a given facility be greater than that depicted on a DSOD-approved map.

**PUBLIC RECORD:** (1) Official dam inundation maps made publicly available prior to June 27, 2017 by the State of California Office of Emergency Services ("OES") pursuant to California Government Code §8589.5; (2) Official inundation boundary digital data made publicly available since June 28, 2017 by the State of California Department of Water Resources (DWR) pursuant to California Water Code §6161. DWR states that its inundation boundary data typically includes flooding depths greater than one foot but some information may be redacted for security purposes.

**VERY HIGH FIRE HAZARD SEVERITY ZONE (VHFHSZ)**

**DISCUSSION:** VHFHSZs can be defined by the California Department of Forestry and Fire Protection ("Calfire") as well as by local fire authorities within "Local Responsibility Areas" where fire suppression is the responsibility of a local fire department. Properties located within VHFHS Zones may have a higher risk for fire damage and, therefore, may be subject to (i) additional construction requirements such as a "Class A" roof for new construction or replacement of existing roofs; and (ii) additional maintenance responsibilities such as adequate vegetation clearance near the structure, spark screens on chimneys and stovepipes, leaf removal from roofs, and other basic fire-safety practices. Contact the local fire department for a complete list of requirements and exceptions.

**PUBLIC RECORD:** Maps issued by Calfire pursuant to California Government Code § 51178 recommending VHFHSZs to be adopted by the local jurisdiction within its Local Responsibility Area, or VHFHSZs adopted by the local jurisdiction within the statutory 120-day period defined in California Government Code § 51179.

**WILDLAND FIRE AREA (STATE RESPONSIBILITY AREA)**

**DISCUSSION:** The State Board of Forestry classifies all lands within the State of California based on various factors such as ground cover, beneficial use of water from watersheds, probable damage from erosion, and fire risks. Fire prevention and suppression in all areas which are not within a Wildland - State Responsibility Area ("WSRA") is primarily the responsibility of the local or federal agencies, as applicable.

For property located within a WSRA, please note that (1) there may be substantial forest fire risks and hazards; (2) except for property located within a county which has assumed responsibility for prevention and suppression of all fires, it is NOT the state's responsibility to provide fire protection services to any building or structure located within a WSRA unless the Department has entered into a cooperative agreement with a local agency; and (3) the property owner may be subject to (i) additional construction requirements such as a "Class A" roof for new construction or replacement of existing roofs; and (ii) additional maintenance responsibilities such as adequate vegetation clearance near the structure, spark screens on chimneys and stovepipes, leaf removal from roofs, and other basic fire-safety practices.

The existence of local agreements for fire service is not available in the Public Record and, therefore, is not included in this disclosure. For very isolated properties with no local fire services or only seasonal fire services there may be significant fire risk. If the Property is located within a WSRA, please contact the local fire department for more detailed information.

**PUBLIC RECORD:** Official maps issued by the California Department of Forestry and Fire Protection ("Calfire") pursuant to California Public Resources Code § 4125.

**SRA Fire Prevention Benefit Fee Advisory**

In 2011, the California Legislature and Governor enacted a "Fire Prevention Fee" on habitable structures in the State's wildland fire responsibility area. The yearly fee, levied on property owners, paid for various activities to prevent and suppress wildfires in the SRA, and was most recently at the rate of \$152.33 per habitable structure on the property.

**Effective July 1, 2017, as authorized by Assembly Bill 398 and signed by the Governor, that fire prevention fee is suspended until 2031.**

For more information, please refer to "Part 6. State Responsibility Area Fire Prevention Fee" in the JCP-LGS Property Tax Report.

**Natural Hazard Disclosure (NHD) Report  
For SAN BERNARDINO County**

**Property Address:** 2760 N LINDEN AVE  
RIALTO, SAN BERNARDINO COUNTY, CA 92377  
("Property")

**APN:** 0239-341-13-0000  
**Report Date:** 10/14/2020  
**Report Number:** 2739237

**EARTHQUAKE FAULT ZONE**

**DISCUSSION:** Earthquake Fault Zones are delineated and adopted by California as part of the Alquist-Priolo Earthquake Fault Zone Act of 1972. Property in an Earthquake Fault Zone ("EF Zone") does not necessarily have a fault trace existing on the site. EF Zones are areas or bands delineated on both sides of known active earthquake faults. EF Zones vary in width but average one-quarter (1/4) mile in width with the "typical" zone boundaries set back approximately 660 feet on either side of the fault trace. The potential for "fault rupture" damage (ground cracking along the fault trace) is relatively high only if a structure is located directly on a fault trace. If a structure is not on a fault trace, shaking will be the primary effect of an earthquake. During a major earthquake, shaking will be strong in the vicinity of the fault and may be strong at some distance from the fault depending on soil and bedrock conditions. It is generally accepted that properly constructed wood-frame houses are resistant to shaking damage.

**PUBLIC RECORD:** Official earthquake fault zone or special study zone maps approved by the State Geologist and issued by the California Department of Conservation, California Geological Survey pursuant to California Public Resources Code §2622.

**SEISMIC HAZARD MAPPING ACT ZONE**

**DISCUSSION:** Official Seismic Hazard Zone ("SH Zone") maps delineate Areas of Potential Liquefaction and Areas of Earthquake-Induced Landsliding. A property that lies partially or entirely within a designated SH Zone may be subject to requirements for site-specific geologic studies and mitigation before any new or additional construction may take place.

**Earthquake-Induced Landslide Hazard Zones** are areas where the potential for earthquake-induced landslides is relatively high. Areas most susceptible to these landslides are steep slopes in poorly cemented or highly fractured rocks, areas underlain by loose, weak soils, and areas on or adjacent to existing landslide deposits. The CGS cautions these maps do not capture all potential earthquake-induced landslide hazards and that earthquake-induced ground failures are not addressed by these maps. Furthermore, no effort has been made to map potential run-out areas of triggered landslides. It is possible that such run-out areas may extend beyond the zone boundaries. An earthquake capable of causing liquefaction or triggering a landslide may not uniformly affect all areas within a SH Zone.

**Liquefaction Hazard Zones** are areas where there is a potential for, or an historic occurrence of liquefaction. Liquefaction is a soil phenomenon that can occur when loose, water saturated granular sediment within 40 feet of the ground surface, are shaken in a significant earthquake. The soil temporarily becomes liquid-like and structures may settle unevenly. The Public Record is intended to identify areas with a relatively high potential for liquefaction but not to predict the amount or direction of liquefaction-related ground displacement, nor the amount of damage caused by liquefaction. The many factors that control ground failure resulting from liquefaction must be evaluated on a site specific basis.

**PUBLIC RECORD:** Official seismic hazard maps or digital data thereof approved by the State Geologist and issued by the California Department of Conservation, California Geological Survey pursuant to California Public Resources Code §2696.

---

**STATUTORY NATURAL HAZARD DISCLOSURE REPORTING STANDARD:** "IN" shall be reported if any portion of the Property is located within any of the above zones as delineated in the Public Record. "NOT IN" shall be reported if no portion of the Property is located within any of the above zones as delineated in the Public Record. Map Not Available shall be reported in areas not yet evaluated by the governing agency according to the Public Record. Please note that "MAP NOT AVAILABLE" will be applicable to most portions of the state. Official Seismic Hazard Zone ("SH Zone") maps delineate Areas of Potential Liquefaction and Areas of Earthquake-Induced Landsliding.

---



**JCP-LGS Residential Resale Property Disclosure Reports**  
**Natural Hazard Disclosure (NHD) Report**  
**For SAN BERNARDINO County**

**Property Address:** 2760 N LINDEN AVE  
RIALTO, SAN BERNARDINO COUNTY, CA 92377  
("Property")

**APN:** 0239-341-13-0000  
**Report Date:** 10/14/2020  
**Report Number:** 2739237

## **Part 2. County and City Defined Natural Hazard Zones**

### **HAZARD MAPS IN THE LOCAL GENERAL PLAN**

**General Plan regulates property development.** There are currently over 530 incorporated cities and counties in California. The state Government Code (Sections 65000 et seq.) requires each of those jurisdictions to adopt a comprehensive, long-term "General Plan" for its physical development. That General Plan regulates land uses within the local jurisdiction in order to protect the public from hazards in the environment and conserve local natural resources. The General Plan is the official city or county policy regarding the location of housing, business, industry, roads, parks, and other land uses.

**Municipal hazard zones can affect the cost of ownership.** Each county and city adopts its own distinct General Plan according to that jurisdiction's unique vegetation, landscape, terrain, and other geographic and geologic conditions. The "Safety Element" (or Seismic Safety Element) of that General Plan identifies the constraints of earthquake fault, landslide, flood, fire and other natural hazards on local land use, and it delineates hazard zones within which private property improvements may be regulated through the building-permit approval process, which can affect the future cost of ownership. Those locally regulated hazard zones are in addition to the federal and state defined hazard zones associated with statutory disclosures in the preceding section.

**City and/or County natural hazard zones explained below.** Unless otherwise specified, only those officially adopted Safety Element or Seismic Safety Element maps (or digital data thereof) which are publicly available, are of a scale, resolution, and quality that readily enable parcel-specific hazard determinations, and are consistent in character with those statutory federal or state disclosures will be considered for eligible for use as the basis for county- or city-level disclosures set forth in this Report. Please also note:

- If an officially adopted Safety Element or Seismic Safety Element map relies on data which is redundant of that used for state-level disclosures, this Report will indicate so and advise Report recipients to refer to the state-level hazard discussion section for more information.
- If an officially adopted Safety Element or Seismic Safety Element cites underlying maps created by another agency, those maps may be regarded as incorporated by reference and may be used as the basis for parcel-specific determinations if those maps meet the criteria set forth in this section.
- Because county- and city-level maps are developed independently and do not necessarily define or delineate a given hazard the same way, the boundaries for the "same" hazard may be different.

If one or more maps contained in the Safety Element and/or Seismic Safety Element of an officially adopted General Plan are used as the basis for local disclosure, those maps will appear under the "Public Record(s) Searched" for that county or city.

#### **REPORTING STANDARDS**

A good faith effort has been made to disclose all hazard features on pertinent Safety Element and Seismic Safety Element maps with well-defined boundaries; however, those hazards with boundaries that are not delineated will be deemed not suitable for parcel-specific hazard determinations. Some map features, such as lines drawn to represent the location of a fault trace, may be buffered to create a zone to facilitate disclosure. Those map features which can not be readily distinguished from those representing hazards may be included to prevent an omission of a hazard feature. If the width of a hazard zone boundary is in question, "IN" will be reported if that boundary impacts any portion of a property. Further explanations concerning specific map features peculiar to a given county or city will appear under the "Reporting Standards" for that jurisdiction.

#### **PUBLIC RECORDS VS. ON-SITE EVALUATIONS**

Mapped hazard zones represent evaluations of generalized hazard information. Any specific site within a mapped zone could be at less or more relative risk than is indicated by the zone designation. A site-specific evaluation conducted by a geotechnical consultant or other qualified professional may provide more detailed and definitive information about the Property and any conditions which may or do affect it.

#### **PROPERTY USE AND PERMITTING**

No maps beyond those identified as "Public Record(s)" have been consulted for the purpose of these local disclosures. These disclosures are intended solely to make Report recipient(s) aware of the presence of mapped hazards. For this reason -- and because local authorities may use on these or additional maps or data differently to determine property-specific land use and permitting approvals -- Report recipients are advised to contact the appropriate local agency, usually Community Development, Planning, and/or Building, prior to the transaction to ascertain if these or any other conditions or related regulations may impact the Property use or improvement.

**JCP-LGS Residential Resale Property Disclosure Reports**  
**Natural Hazard Disclosure (NHD) Report**  
**For SAN BERNARDINO County**

**Property Address:** 2760 N LINDEN AVE  
RIALTO, SAN BERNARDINO COUNTY, CA 92377  
("Property")

**APN:** 0239-341-13-0000  
**Report Date:** 10/14/2020  
**Report Number:** 2739237

**SAN BERNARDINO COUNTY OVERLAY ZONES DISCUSSION**

**PUBLIC RECORD(S) SEARCHED:** The following Public Records, incorporated by reference in the County Safety Element (and discussed at length in the related County Geologic Hazard Background Report) of the General Plan as adopted by the County Board of Supervisors in 2007 and updated in 2010, are utilized for those County-level disclosures below: "Geologic Hazard Overlay," "Flood Plain Safety Overlay," and "Fire Safety Overlay" digital data provided by the County.

**FAULT ZONES**

San Bernardino County is crossed by numerous faults that have been, and could potentially be, the sources of moderate to large and potentially damaging earthquakes. While the County has officially adopted those "Earthquake Fault Zones" identified pursuant to the Alquist-Priolo Earthquake Fault Zoning Act for which disclosure is statutory, the Public Record also delineates the boundaries of "County Designated Fault Zones."

**Reporting Standards:** If any portion of the Property is located within either an "Earthquake Fault Zone" or a "County Designated Fault Zone" as delineated in the Public Record, "WITHIN" shall be reported.

**LIQUEFACTION POTENTIAL**

Liquefaction potential exists where relatively loose, sandy soils exist with high groundwater level (less than 50 feet in depth) during long duration, high seismic ground shaking. Areas of the Valley Region that have liquefaction potential include the alluvial fans at the mouths of mountain canyons and river floodplain deposits along the Santa Ana River, Cajon Creek, and Lytle Creek. Within the Mountain and Desert Regions there are areas where alluvial deposits exist with relatively shallow groundwater, indicating the potential for liquefaction. These include areas along the Mojave River; areas adjacent to certain faults that form groundwater barriers such as local areas southwest of the Calico fault near Barstow, southwest of the Helendale fault in Lucerne Valley, and southwest of the Lockhart fault west of Barstow; the Mojave River Wash area south of the intersection of Interstate 15 and Basin Road; the area between Baker and Silver Lake; a small area between Big Bear Lake and Erwin Lake with high groundwater levels, and a small area between Big Bear Lake and Baldwin Lake. Please note that in March 2010 the County added new liquefaction susceptibility data for the Big Bear area for which data was previously not available. While many Valley and Mountain Region potential liquefaction areas are clearly delineated in the Public Record, those in the Desert Region are not.

**Reporting Standards:** If any portion of the Property is located within an area of Liquefaction Susceptibility as delineated in the Public Record, "IN" shall be reported. "Map Not Available" shall be reported for areas for which no data is available.

**EXISTING LANDSLIDES**

Landslides typically occur in hillside or mountainous terrain, and occurrences are generally influenced by the nature of the rock or soil type, slope angle, groundwater levels, and precipitation. New or existing landslides can also be influenced by construction activity, unusual natural or artificial wetting (such as irrigation), or erosion. Other equally important factors contributing to landslides are the relationship of discontinuity (bedding, foliation, joints, and faults) orientation of the rock in relation to the slope direction, the physical condition and degree of weathering of the rock and soil, and the frequency, location, and magnitude of earthquakes. The Public Record used as the basis for this disclosure represents a combination of findings from three separate geological studies.

**Reporting Standards:** If any portion of the Property is located within a mapped "existing landslide" as delineated in the Public Record, "IN" shall be reported.

**LANDSLIDE SUSCEPTIBILITY**

Different areas of the County have different levels of susceptibility to landslide activity. Areas of moderate relief, such as in the Chino Hills, or in areas adjacent to high relief, such as along the southern fronts of the San Gabriel and San Bernardino Mountains, are areas of concern. Localized areas in the Valley Region that have landslide potential include river banks and the areas surrounding large open excavations, such as quarries. Landslides of all types are common in the Mountain Region of the County due to steep slopes, sharp narrow ridges, and steep-walled incised canyons and valleys, when combined with adverse geologic structure, high precipitation, and earthquakes. The landslides range in size from small rock falls or topples along road cuts to large landslide complexes.

**Reporting Standards:** The area in which the Property is located with the highest Landslide Susceptibility ("High," "Medium-High," "Low-Medium," or "Low") as delineated in the Public Record shall be reported. "Map Not Available" shall be reported for areas for which no data is available. Please note that because subsurface conditions can vary over a relatively short distance in an area, some areas delineated as susceptible to landsliding may not actually be susceptible to landsliding. In addition, there may be localized areas that are susceptible to landsliding that have not been identified.

**FIRE SAFETY AREA**

The Fire Safety Overlay is created to provide greater public safety in areas prone to wildland brush fires by establishing additional development standards for these areas. The County has established three "Fire Safety Areas":

- **Fire Safety Area 1 (FS1)**, which includes areas within the mountains and valley foothills, is characterized by areas with moderate to steep terrain and moderate to heavy fuel loading.

**Natural Hazard Disclosure (NHD) Report  
For SAN BERNARDINO County**

**Property Address:** 2760 N LINDEN AVE  
RIALTO, SAN BERNARDINO COUNTY, CA 92377  
("Property")

**APN:** 0239-341-13-0000  
**Report Date:** 10/14/2020  
**Report Number:** 2739237

- **Fire Safety Area 2 (FS2)**, which includes areas lands just to the north and east of the mountain FS1 area in the mountain-desert interface, is characterized by areas with gentle to moderate sloping terrain and light to moderate fuel loading. In addition, these areas are periodically subject to high wind conditions that have the potential to spread wildfire.
- **Fire Safety Area 3 (FS3)**, which includes areas just south of the mountain FS1 area, is characterized by varying terrain from relatively flat to steeply sloping hillside areas. Present and future development is exposed to the impacts of wildland fires and other natural hazards primarily due to its proximity to FS1. These areas are subject to Santa Ana wind conditions that have the potential to spread wildfire.

**Reporting Standards:** If a Property is within a Fire Safety Area as delineated in the Public Record, "IN" shall be reported. If the Property is in more than one Fire Safety Area, the highest numbered ("1" being the highest) shall be reported. "NOT IN" shall be reported for those areas of the County not delineated in the Public Record as a Fire Safety Area. Please note the Public Record has a positional accuracy of +/- 750 feet.

**AREAS OF SHALLOW FLOODING (PHELAN AREA ONLY)**

In 2008, FEMA completed their Digital Flood Insurance Rate Map (DFIRM) conversion and updated a number of flood zone areas in San Bernardino County. At that time FEMA designated large portions of the Phelan area Zone D, defined as an area with possible but undetermined flood hazards for which no flood analysis has been conducted. The County has since designated much of this area as a "Flood Plain Review Area 3" ("FP3") which includes areas of shallow flooding with undetermined, but possible, flood hazards. New developments within this and other Flood Plain Review Areas are subject to corresponding provisions of the County Development Code (Section 82.14.040).

**Reporting Standards:** If any portion of the Property is located within a "Flood Plain Review Area 3" as delineated in the Public Record, "IN" shall be reported. If a Property is within that portion of the designated Study Area for which FP3 data is not provided, or located outside the Study Area, "Map Not Available" shall be reported. For those properties for which "Map Not Available" is applicable, please refer to the state-level discussion and disclosure of Special Flood Hazard Area and the Special Flood Hazard Area determination.

**JCP-LGS Residential Resale Property Disclosure Reports**  
**Natural Hazard Disclosure (NHD) Report**  
**For SAN BERNARDINO County**

**Property Address:** 2760 N LINDEN AVE  
RIALTO, SAN BERNARDINO COUNTY, CA 92377  
("Property")

**APN:** 0239-341-13-0000  
**Report Date:** 10/14/2020  
**Report Number:** 2739237

**CITY OF RIALTO GEOLOGIC DISCUSSION**

**PUBLIC RECORD(S) SEARCHED:** The following Public Record(s), incorporated into the Safety and Noise Chapter of the City of Rialto General Plan as officially adopted in 2010, are used for the city-level disclosure(s) below: "Exhibit 5.1: Seismic and Geologic Hazards".

**FAULT**

The San Jacinto, San Andreas, and Cucamonga faults, all classified as Alquist-Priolo Earthquake Fault Zones, have the potential of generating earthquakes of maximum magnitudes from 6.7 to 8.0 and impacting the City of Rialto. In addition to these regulatory zone faults, the Public Record identifies the location of other faults, groundwater barriers, and lineaments. The groundwater barriers, labeled Barrier H (originally referred to as the Rialto-Colton Fault) and Barrier J, are not strictly regarded as faults because they do not have surface expressions and are only approximately located based largely on hydrological evidence. The third fault, represented as a series of lineaments identified in aerial photos, impacts an area of the City roughly bounded by Foothill Boulevard on the south, Baseline Road on the north, Cedar Avenue on the east, and Maple Avenue on the west. This fault (or set of faults) has been mapped at that location based on a pronounced concentration of microearthquakes (referred to as the "Fontana Seismic Trend") that have been reported along this line for many years.

**Reporting Standards:** California's Alquist-Priolo Fault Zone Act (1972) established a standard for the width of a regulatory fault zone -- one-eighth of one mile on both sides of an active fault trace. For city-level reporting purposes, "WITHIN" shall be reported if any portion of the Property is within one-eighth of one mile (660 feet) of a fault, lineament, or groundwater barrier delineated in the Public Record that is not bounded by a regulatory fault zone. "NOT WITHIN" shall be reported if no portion of the Property is situated within one-eighth of one mile (660 feet) of an unzoned fault trace, lineament, or groundwater barrier delineated in the Public Record. Alquist-Priolo Earthquake Fault Zones, defined by the State Geologist, are also mapped in the Public Record, but they are disclosed in the state-level section of this Report.

**OTHER MAPPED HAZARDS**

"FEMA Flood Zones" delineated in "Exhibit 5.2: Flooding Hazards" have since been superseded by newer official FEMA flood zone data. For the most current FEMA flood zone information please refer to the state-level discussion and disclosure of Special Flood Hazard Area. The fire zone boundaries delineated for State Responsibility Areas and Local Responsibility Areas in "Exhibit 5.3: Fire Hazards" are redundant of those recently adopted and subject to state-level statutory disclosure as Wildland State Responsibility Areas and Very High Fire Hazard Severity Zones. The boundary of the "Moderate liquefaction susceptibility" area within the City's Sphere of Influence is redundant of that disclosed in this Report for the county-level.

**The following natural hazard(s) is/are discussed at length but not mapped in the City General Plan:**

**GROUND SHAKING**

The greatest source of earthquake damage is caused by ground shaking. Rialto is susceptible to ground shaking caused by the several local fault systems. Historically, Rialto has experienced moderate to strong ground shaking associated with such events as the 1812 Wrightwood earthquake (estimated 7.5 magnitude), 1899 Cajon Pass earthquake (estimated 5.7 magnitude), 1933 Long Beach earthquake (6.4 magnitude), 1971 Sylmar earthquake (6.6 magnitude), and 1994 Northridge earthquake (6.7 magnitude). The earthquake magnitudes which these area faults are capable of generating would cause even moderate damage to buildings constructed with the latest building codes.

**Reporting Standards:** No determination is reported because the Public Record does not include a map which delineates the boundaries for ground shaking hazard zones within the City Planning Area.

**WIND**

The City of Rialto has a history of extensive windstorms, often related to Santa Ana winds that push through the Cajon Pass. The Santa Ana winds are strong, extremely dry offshore winds that characteristically sweep through the area in late fall and early winter. High winds can also result from thunderstorm inflow and outflow or high and low pressure systems moving through the region. High winds have speeds reaching at least 50 miles per hour, and gusts can exceed 100 miles per hour. Wind events constitute one of the most frequent major hazards in the City. Not only do windstorms happen frequently, they can be costly in terms of property damage and can cause injury to people. The winds affecting Rialto, which sometimes reach gale-force strength, can damage structures, uproot small trees, and create dust storms in the City where the soil type is susceptible to wind erosion. Winds can also push wildland fires in the Lytle Creek area. Additionally, as the northern part of the City has shifted to developed lands, the severity and frequency of high winds has been reduced moderately.

**Reporting Standards:** No determination is reported because the Public Record does not include a map which delineates the boundaries for these wind hazard zones within the City Planning Area.

**END OF LOCAL AREA DISCLOSURES AND DISCUSSIONS SECTION**

**JCP-LGS Residential Resale Property Disclosure Reports**  
**Natural Hazard Disclosure (NHD) Report**  
**For SAN BERNARDINO County**

**Property Address:** 2760 N LINDEN AVE  
RIALTO, SAN BERNARDINO COUNTY, CA 92377  
("Property")

**APN:** 0239-341-13-0000  
**Report Date:** 10/14/2020  
**Report Number:** 2739237

### **Part 3. Additional Property Specific Disclosures**

#### **FORMER MILITARY ORDNANCE SITE DISCLOSURE**

**DISCUSSION:** Former Military Ordnance (FUD) sites can include sites with common industrial waste (such as fuels), ordnance or other warfare materiel, unsafe structures to be demolished, or debris for removal. California Civil Code Section 1102 requires disclosure of those sites containing unexploded ordnance. "Military ordnance" is any kind of munitions, explosive device/material or chemical agent used in military weapons. Unexploded ordnance are munitions that did not detonate. NOTE: **MOST** FUD sites do not contain unexploded ordnance. Only those FUD sites that the U.S. Army Corps of Engineers (USACE) has identified to contain Military Ordnance or have mitigation projects planned for them are disclosed in this Report. Additional sites may be added as military installations are released under the Federal Base Realignment and Closure (BRAC) Act. Active military sites are NOT included on the FUD site list.

**PUBLIC RECORD:** Data contained in Inventory Project Reports, Archives Search Reports, and related materials produced for, and made publicly available in conjunction with, the Defense Environmental Restoration Program for Formerly Used Defense Sites by the U.S. Army Corps of Engineers. Sites for which no map has been made publicly available shall not be disclosed.

**REPORTING STANDARD:** If one or more facility identified in the Public Record is situated within a one (1) mile radius of the Property, "**WITHIN**" shall be reported. The name of that facility or facilities shall also be reported.

#### **COMMERCIAL OR INDUSTRIAL ZONING DISCLOSURE**

**DISCUSSION:** The seller of real property who has actual knowledge that the property is affected by or zoned to allow commercial or industrial use described in Section 731a of the Code of Civil Procedure shall give written notice of that knowledge to purchasers as soon as practicable before transfer of title (California Civil Code Section 1102.17). The Code of Civil Procedure Section 731a defines industrial use as areas in which a city and/or county has established zones or districts under authority of law wherein certain manufacturing or commercial or airport uses are expressly permitted. The "Zoning Disclosure" made in this Report DOES NOT purport to determine whether the subject property is or is not affected by a commercial or industrial zone. As stated above, that determination is based solely upon ACTUAL KNOWLEDGE of the seller of the subject property.

In an effort to help determine areas where this may be applicable, this disclosure identifies if a property exists within one mile of the seller's property that is zoned to allow for commercial or industrial use. Very commonly, a home will have in its vicinity one or more properties that are zoned for commercial or industrial use such as restaurants, gasoline stations, convenience stores, golf courses, country club etc.

**PUBLIC RECORD:** Based on publicly-available hardcopy and/or digital zoning and land use records for California cities and counties.

**REPORTING STANDARD:** If one or more property identified in the Public Record as "commercial," "industrial," or "mixed use" is situated within a one (1) mile radius of the Property, "**WITHIN**" shall be reported. Please note that an airport facility that may be classified as public use facility in the Public Record will be reported as "commercial/industrial" in this disclosure.



**JCP-LGS Residential Resale Property Disclosure Reports**  
**Natural Hazard Disclosure (NHD) Report**  
**For SAN BERNARDINO County**

**Property Address:** 2760 N LINDEN AVE  
RIALTO, SAN BERNARDINO COUNTY, CA 92377  
("Property")

**APN:** 0239-341-13-0000  
**Report Date:** 10/14/2020  
**Report Number:** 2739237

**AIRPORT INFLUENCE AREA DISCLOSURE**

**DISCUSSION:**

If any portion of the Property is in either an officially designated "airport influence area" ("AIA") or a two mile radius of a qualifying facility for which an AIA has not yet been officially designated, the following Notice is required:

**NOTICE OF AIRPORT IN VICINITY**

If this property is presently located in the vicinity of an airport, as identified in the determination section of this Report, within what is known as an airport influence area...the property may be subject to some of the annoyances or inconveniences associated with proximity to airport operations (for example: noise, vibration, or odors). Individual sensitivities to those annoyances can vary from person to person. In that case, you may wish to consider what airport annoyances, if any, are associated with the property before you complete your purchase and determine whether they are acceptable (California Civil Code, Section 1103.4).

**Certain airports are not disclosed in this Report.** JCP-LGS has made a good faith effort to identify the airports covered under Section 1102.6a. Sources consulted include official land use maps and/or digital data made available by a governing Airport Land Use Commission (ALUC) or other designated government body. Most facilities for which an Airport Influence Area has been designated are included on the "California Airports List" maintained by the California Department of Transportation's Division of Aeronautics. Not disclosed in this Report are public use airports that are not in the "California Airports List", airports that are physically located outside California, heliports and seaplane bases that do not have regularly scheduled commercial service, and private airports or military air facilities unless specifically identified in the "California Airports List". **If the seller has actual knowledge of an airport in the vicinity of the subject property that is not disclosed in this Report, and that is material to the transaction, the seller should disclose this actual knowledge in writing to the buyer.**

Most facilities for which an Airport Influence Area has been designated are included on the "California Airports List" maintained by the California Department of Transportation's Division of Aeronautics. The inclusion of military and private airports varies by County, and heliports and seaplane bases are not included, therefore, airports in these categories may or may not be included in this disclosure.

**NOTE:** Proximity to an airport does not necessarily mean that the property is exposed to significant aviation noise levels. Alternatively, there may be properties exposed to aviation noise that are greater than two miles from an airport. Factors that affect the level of aviation noise include weather, aircraft type and size, frequency of aircraft operations, airport layout, flight patterns or nighttime operations. Buyer should be aware that aviation noise levels can vary seasonally or change if airport usage changes.

**PUBLIC RECORD:** Based on officially adopted land use maps and/or digital data made publicly available by the governing ALUC or other designated government body. If the ALUC or other designated government body has not made publicly available a current officially adopted airport influence area map, then California law states that "a written disclosure of an airport within two (2) statute miles shall be deemed to satisfy any city or county requirements for the disclosure of airports in connection with transfers of real property."

**REPORTING STANDARD:** "IN" shall be reported along with the facility name(s) and the "Notice of Airport in Vicinity" if any portion of the Property is situated within either (a) an Airport Influence Area as designated on officially adopted maps or digital data or (b) a two (2) mile radius of a qualifying facility for which an official Airport Influence Area map or digital data has not been made publicly available by the ALUC or other designated governing body. "NOT IN" shall be reported if no portion of the Property is within either area.

**JCP-LGS Residential Resale Property Disclosure Reports**  
**Natural Hazard Disclosure (NHD) Report**  
**For SAN BERNARDINO County**

**Property Address:** 2760 N LINDEN AVE  
RIALTO, SAN BERNARDINO COUNTY, CA 92377  
("Property")

**APN:** 0239-341-13-0000  
**Report Date:** 10/14/2020  
**Report Number:** 2739237

**AIRPORT NOISE DISCLOSURE**

**DISCUSSION:** California Civil Code §1102.17 requires the seller(s) of residential real property who has/have actual knowledge that the property in the transaction is affected by airport use must give written notice of that knowledge, as soon as practicable, before transfer of title.

Under the Federal Aviation Administration's *Airport Noise Compatibility Planning Program Part 150*, certain 65 decibel (dB) Community Noise Equivalent Level (CNEL) contour maps have been produced for some airports. Not all airports have produced noise exposure maps. A property may be near or at some distance from an airport and not be within a delineated noise exposure area, but still experience aviation noise. Unless 65dB CNEL contour maps are published, helipads and military sites are not included in this section of the Report.

The *Airport Noise Compatibility Planning Program* is voluntary and not all airports have elected to participate. Furthermore, not all property in the vicinity of an airport is exposed to 65dB CNEL or greater average aviation noise levels. Conversely a property may be at some distance from an airport and still experience aviation noise. Buyer should be aware that aviation noise levels can vary seasonally or change if airport usage changes after a map is published or after the Report Date. JCP-LGS uses the most seasonally conservative noise exposures provided.

Federal funding may be available to help airports implement noise reduction programs. Such programs vary and may include purchasing properties, rezoning, and insulating homes for sound within 65dB areas delineated on CNEL maps. Airport owners have also cooperated by imposing airport use restrictions that include curfews, modifying flight paths, and aircraft limitations.

**PUBLIC RECORD:** Certain 65 decibel (dB) Community Noise Equivalent Level (CNEL) contour maps produced under the Federal Aviation Administration's *Airport Noise Compatibility Planning Program Part 150*.

**REPORTING STANDARD:** "IN" shall be reported if any portion of the Property is situated within a 65 decibel Community Noise Equivalent Level contour identified in the Public Record. "NOT IN" shall be reported if no portion of the Property is situated within a 65 decibel Community Noise Equivalent Level contour identified in the Public Record.

**JCP-LGS Residential Resale Property Disclosure Reports**  
**Natural Hazard Disclosure (NHD) Report**  
**For SAN BERNARDINO County**

**Property Address:** 2760 N LINDEN AVE  
RIALTO, SAN BERNARDINO COUNTY, CA 92377  
("Property")

**APN:** 0239-341-13-0000  
**Report Date:** 10/14/2020  
**Report Number:** 2739237

**CALIFORNIA ENERGY COMMISSION DUCT SEALING & TESTING REQUIREMENT**

**DISCUSSION:** According to the California Energy Commission ("CEC") most California homes have improperly sealed central air conditioning and heating system ducts such that approximately 30 percent of the conditioned air actually leaks outside the home.

Effective July 1, 2014, in order to combat this waste of energy and money, the CEC updated its residential duct sealing and testing requirements in the 2013 Building Energy Efficiency Standards (Title 24). Previously, such duct sealing and testing was required only in certain CEC-designated climate zones when a central air conditioner or furnace is installed or replaced. **The revised standards now make duct sealing and testing mandatory in all California climate zones when such a system is installed or replaced.** Ducts found to leak more than 15 percent or more must be repaired. Once a contractor tests and fixes these ducts, you must have an approved third-party verifier determine that the ducts have been properly sealed. The CEC cautions homeowners that a contractor who fails to obtain a required building permit and fails to test and repair your ducts "is violating the law and exposing you to additional costs and liability." If you do not obtain a permit, you may be required to bring your home into compliance with code requirements for that work and may incur additional penalties and fines that have to be paid prior to selling your home. Remember that you have a duty to disclose whether you obtained required permits for work performed to prospective Buyers and appraisers. Local governments may mandate more stringent requirements.

Please note there are specific alternatives that allow high efficiency equipment and added duct insulation to be installed instead of fixing duct leaks. Please also be advised that there are separate regulations which govern duct insulation levels required by climate zone and HVAC system.

For more information please contact the California Energy Commission or visit the official CEC "2013 Building Energy Efficiency Standards" portal at: <http://www.energy.ca.gov/title24/2013standards/index.html>

**PUBLIC RECORD:** 2013 Building Energy Efficiency Standards (Title 24).

**REPORTING STANDARD:** "WITHIN" shall be reported regardless of CEC-designated climate zone pursuant to the revised Title 24 Standards.

**COOLING AND HEATING ENERGY-EFFICIENCY ADVISORY**

Effective January 1, 2015, new federal energy-efficiency standards apply to the repair and replacement of residential heating, ventilation and air conditioning ("HVAC") systems. The new standards raise the minimum efficiency requirements for air conditioning systems and certain types of heating systems. Energy efficiency is measured by the Seasonal Energy Efficiency Ratio ("SEER"), which compares the amount of cooling (or heating) output by an HVAC system to the amount of energy (electricity or gas) input over its operating season. The higher the system's SEER value, the more energy-efficient it is and the lower the unit cost of cooling (or heating) a home.

For the first time, federal minimum-efficiency standards will vary by region. Prior to 2015 one standard, called SEER 13, applied nationwide. Now, in California, Nevada, Arizona and New Mexico (the Southwestern Region), SEER 13 has been replaced by the more efficient SEER 14 standard. In the Southwestern Region the new rule allows repairs to existing SEER 13-compliant systems. However, in many cases a full system replacement (both the indoor and outdoor unit) will be necessary to make the system compatible, and replacement is allowed only with a SEER 14-compliant unit. The higher standard may increase the replacement cost to the property owner because the SEER 14 efficiency improvements require increased complexity of the new equipment, and the SEER 14 units may not fit in the existing space, requiring structural modifications at the owner's expense. In some cases the SEER 14 standard could double the cost of replacement over the earlier replacement cost. For applicable details and codes, see the California Energy Commission web page at: [http://www.energy.ca.gov/title24/2013standards/residential\\_manual.html](http://www.energy.ca.gov/title24/2013standards/residential_manual.html) (The new federal standards go into effect on January 1, 2015, which is six months after the July 1, 2014, effective date of the 2013 Standards.) Federal energy-efficiency standards are updated from time to time. To determine the current applicable federal standard inquire with a home inspector or other appropriately licensed professional.

**JCP-LGS Residential Resale Property Disclosure Reports**  
**Natural Hazard Disclosure (NHD) Report**  
**For SAN BERNARDINO County**

**Property Address:** 2760 N LINDEN AVE  
RIALTO, SAN BERNARDINO COUNTY, CA 92377  
("Property")

**APN:** 0239-341-13-0000  
**Report Date:** 10/14/2020  
**Report Number:** 2739237

**STATEWIDE RIGHT TO FARM DISCLOSURE**

**DISCUSSION:**

If the property is presently located within one mile of a parcel of real property designated as "Prime Farmland," "Farmland of Statewide Importance," "Unique Farmland," "Farmland of Local Importance," or "Grazing Land" on the most current "Important Farmland Map" issued by the California Department of Conservation, Division of Land Resource Protection, the following notice is required:

**NOTICE OF RIGHT TO FARM**

This property is located within one mile of a farm or ranch land designated on the current county-level GIS "Important Farmland Map," issued by the California Department of Conservation, Division of Land Resource Protection. Accordingly, the property may be subject to inconveniences or discomforts resulting from agricultural operations that are a normal and necessary aspect of living in a community with a strong rural character and a healthy agricultural sector. Customary agricultural practices in farm operations may include, but are not limited to, noise, odors, dust, light, insects, the operation of pumps and machinery, the storage and disposal of manure, bee pollination, and the ground or aerial application of fertilizers, pesticides, and herbicides. These agricultural practices may occur at any time during the 24-hour day. Individual sensitivities to those practices can vary from person to person. You may wish to consider the impacts of such agricultural practices before you complete your purchase. Please be advised that you may be barred from obtaining legal remedies against agricultural practices conducted in a manner consistent with proper and accepted customs and standards pursuant to Section 3482.5 of the Civil Code or any pertinent local ordinance.

California has a "Right to Farm Act" (Civil Code Section 3482.5) to protect farming operations. When agricultural land within the State's agricultural areas is bought and sold, the purchasers are often not made aware of the fact that there are right-to-farm laws. This has led to confusion and a misunderstanding of the actual uses of the land or uses of the surrounding agricultural lands.

In 2008 the State of California enacted Assembly Bill 2881 to limit the exposure of farmers to nuisance lawsuits by homeowners in neighboring developments. The mechanism of this bill is a formal notification of the Buyer, through a "Notice of Right to Farm" in an expert disclosure report that advises the Buyer if the subject property is within one mile of farmland as defined in the bill.

**If the seller has actual knowledge of an agricultural operation in the vicinity of the subject property that is not disclosed in this Report, and that is material to the transaction, the seller should disclose this actual knowledge in writing to the Buyer.**

**PUBLIC RECORD:** Based on the most current available version of the "Important Farmland Map" issued by the California Department of Conservation, Division of Land Resource Protection, utilizing solely the county-level GIS map data, if any, available on the Division's Farmland Mapping and Monitoring Program website, pursuant to Section 11010 of the Business and Professions Code, and Section 1103.4 of the California Civil Code.

**REPORTING STANDARD:** "IN" shall be reported and the "Notice of Right to Farm" provided if any portion of the Property is situated within, or within one mile of, a parcel of real property designated as "Prime Farmland," "Farmland of Statewide Importance," "Unique Farmland," "Farmland of Local Importance," or "Grazing Land" in the public record. "NOT IN" shall be reported if no portion of the Property is within that area.

Some counties, or parts thereof, are not included in the Public Record because they have not been mapped for farmland parcels under this State program. Typically, this is because the county area is public land and not planned for incorporation, or, in the case of San Francisco, the county is entirely incorporated. In those instances, we report "Map Not Available" above, or "Map N/A" in the table of summary determinations at the beginning of this Report.

**JCP-LGS Residential Resale Property Disclosure Reports**  
**Natural Hazard Disclosure (NHD) Report**  
**For SAN BERNARDINO County**

**Property Address:** 2760 N LINDEN AVE  
RIALTO, SAN BERNARDINO COUNTY, CA 92377  
("Property")

**APN:** 0239-341-13-0000  
**Report Date:** 10/14/2020  
**Report Number:** 2739237

**NOTICE OF MINING OPERATIONS DISCLOSURE**

**DISCUSSION:** Historically mining operations have been located in remote areas. However, increasing urbanization has resulted in some residential projects being developed near existing mining operations.

California Public Resources Code §2207 requires owners and operators of mining operations to provide annually specific information to the California Department of Conservation ("DOC"), including but not limited to, (i) ownership and contact information, and (ii) the latitude, longitude, and approximate boundaries of the mining operation marked on a specific United States Geological Survey map. The Office of Mining Reclamation ("OMR") is a division of the DOC. Using the mandatory data specified above, OMR provides map coordinate data that can be used by GIS systems to create points representing mine locations ("OMR Maps"). For more information please visit OMR's Mines OnLine Map Viewer (<http://maps.conservation.ca.gov/mol/index.html>).

Effective January 1, 2012, California Civil Code §1103.4 requires the seller of residential property to disclose to a Buyer if the residential property is located with one (1) mile of mining operations as specified on OMR Maps.

**Special Notes:**

1. This statutory disclosure does not rely on the OMR's "AB 3098 List," a list of mines regulated under the Surface Mining and Reclamation Act of 1975 ("SMARA") that meet provisions set forth under California Public Resources Code §2717(b). The AB 3098 List does not include map coordinate data as required under California Public Resources Code §2207 and may not include all mining operations subject to the "Notice of Mining Operations" disclosure.

2. This "Notice of Mining Operations" disclosure is not satisfied by disclosing abandoned mines. An abandoned mine is NOT an operating mine. California Civil Code §1103.4 is satisfied only by disclosing based on OMR Maps.

**PUBLIC RECORD:** Mining operations as provided on OMR Maps made publicly available by DOC pursuant to California law.

**REPORTING STANDARD:** "IN" is reported if any portion of the Property is located within a one (1) mile radius of one or more mining operation(s) identified in the Public Record for which map coordinate data is provided. If "IN", the name of the mining operation(s) as it appears in the Public Record is also reported. "NOT IN" is reported if no portion of the Property is located within a one (1) mile radius of a mining operation specified on OMR Maps.



**JCP-LGS Residential Resale Property Disclosure Reports**  
**Natural Hazard Disclosure (NHD) Report**  
**For SAN BERNARDINO County**

**Property Address:** 2760 N LINDEN AVE  
RIALTO, SAN BERNARDINO COUNTY, CA 92377  
("Property")

**APN:** 0239-341-13-0000  
**Report Date:** 10/14/2020  
**Report Number:** 2739237

## **Part 4. General Advisories**

### **REGISTERED SEX OFFENDER DATABASE DISCLOSURE REQUIREMENT ("MEGAN'S LAW")**

**Notice:** Pursuant to Section 290.46 of the Penal Code, information about specified registered sex offenders is made available to the public via an Internet Web site maintained by the Department of Justice at [www.meganslaw.ca.gov](http://www.meganslaw.ca.gov). Depending on an offender's criminal history, this information will include either the address at which the offender resides or the community of residence and ZIP Code in which he or she resides.

**DISCUSSION:** California law (AB 488), signed by the Governor on September 24, 2004, provides the public with Internet access to detailed information on registered sex offenders. The Sex Offender Tracking Program of the California Department of Justice (DOJ) maintains the database of the locations of persons required to register pursuant to paragraph (1) of subdivision (a) of Section 290.46 of the Penal Code. The online database is updated with data provided by local sheriff and police agencies on an ongoing basis. It presents offender information in 13 languages; may be searched by a sex offender's specific name, zip code, or city/county; provides access to detailed personal profile information on each registrant; and includes a map of your neighborhood.

**California Department of Justice Information Sources:**

Megan's Law Sex Offender Locator Web Site: <http://www.meganslaw.ca.gov>

California Department of Justice Megan's Law Email Address: [meganslaw@doj.ca.gov](mailto:meganslaw@doj.ca.gov)

**Local Information Locations For The Property:**

All sheriffs departments and every police department in jurisdictions with a population of 200,000 or more are required to make a CD-ROM available free to the public for viewing. Although not required, many other law enforcement departments in smaller jurisdictions make the CD-ROM available as well. Please call the local law enforcement department to investigate availability.

***The following are the law enforcement departments in your county that are REQUIRED to make information available:***

<b>San Bernardino County Sheriff Department</b>	<b>(909) 387-3615</b>
---	-----------------------

**Explanation and How to Obtain Information**

For over 50 years, California has required certain sex offenders to register with their local law enforcement agencies. However, information on the whereabouts of the sex offenders was not available to the public until implementation of the Child Molester Identification Line in July 1995. The available information was expanded by California's "Megan's Law" in 1996 (Chapter 908, Stats. of 1996). Megan's Law provides certain information on the whereabouts of "serious" and "high-risk" sex offenders. The law specifically prohibits using the information to harass or commit any crime against the offender. The information on a registered sex offender includes: name and known aliases; age and sex; physical description, including scars, marks and tattoos; photograph, if available; crimes resulting in registration; county of residence; and zip code (from last registration). Accessing the online database requires agreement to the DOJ's terms of use on the web page.

**Natural Hazard Disclosure (NHD) Report  
For SAN BERNARDINO County**

**Property Address:** 2760 N LINDEN AVE  
RIALTO, SAN BERNARDINO COUNTY, CA 92377  
("Property")

**APN:** 0239-341-13-0000  
**Report Date:** 10/14/2020  
**Report Number:** 2739237

**GAS AND HAZARDOUS LIQUID TRANSMISSION PIPELINE  
DATABASE DISCLOSURE REQUIREMENT**

**DISCUSSION:** Following a number of pipeline disasters in the U.S., such as the 2010 San Bruno explosion in Northern California, there is an increased awareness of the potential dangers associated with underground transmission pipelines. As a result, the California Legislature unanimously passed Assembly Bill 1511 (Bradford), signed by Governor Jerry Brown on July 13, 2012. This law, which becomes effective January 1, 2013, is chaptered as California Civil Code Section 2079.10.5 and mandates the disclosure of the following notice to Buyers:

**NOTICE REGARDING GAS AND HAZARDOUS LIQUID  
TRANSMISSION PIPELINES**

This notice is being provided simply to inform you that information about the general location of gas and hazardous liquid transmission pipelines is available to the public via the National Pipeline Mapping System (NPMS) Internet Web site maintained by the United States Department of Transportation at <http://www.npms.phmsa.dot.gov/>. To seek further information about possible transmission pipelines near the property, you may contact your local gas utility or other pipeline operators in the area. Contact information for pipeline operators is searchable by ZIP Code and county on the NPMS Internet Web site. (California Civil Code Section 2079.10.5(a))

*Civil Code Section 2079.10.5(c) adds, "Nothing in this section shall alter any existing duty under any other statute or decisional law imposed upon the seller or broker, including, but not limited to, the duties of a seller or broker under this article, or the duties of a seller or broker under Article 1.5 (commencing with Section 1102) of Chapter 2 of Title 4 of Part 4 of Division 2."*

Such "existing duties" include the disclosure of actual knowledge about a potential hazard, such as may be created by the delivery of a letter from the local utility company informing the seller that a gas transmission pipeline exists within 2,000 feet of the Property.

**Beginning on the law's January 1, 2013, effective date,** except where such "existing duties" apply, "Upon delivery of the notice to the transferee of the real property, the seller or broker is not required to provide information in addition to that contained in the notice regarding gas and hazardous liquid transmission pipelines in subdivision (a). The information in the notice shall be deemed to be adequate to inform the transferee about the existence of a statewide database of the locations of gas and hazardous liquid transmission pipelines and information from the database regarding those locations." (California Civil Code Section 2079.10.5(b))

The disclosure of underground transmission pipelines helps the parties in a real estate transaction make an informed decision and is in the best interest of the public. Buyer should be aware that, according to the NPMS Internet Web site, gas and/or hazardous liquid transmission pipelines are known to exist in 49 of California's 58 counties, the exceptions being in rural mountainous parts of the state. Every home that utilizes natural gas is connected to a gas "distribution" pipeline, which is generally of smaller size and lower pressure than a transmission pipeline.

**For More Information**

To investigate whether any pipeline easement (right-of-way) exists on the Property, Buyer should review the Preliminary Title Report. **Buyer should consult an attorney for interpretation of any law. This notice is for information purposes only and should not be construed as legal advice.**

**Natural Hazard Disclosure (NHD) Report  
For SAN BERNARDINO County**

**Property Address:** 2760 N LINDEN AVE  
RIALTO, SAN BERNARDINO COUNTY, CA 92377  
("Property")

**APN:** 0239-341-13-0000  
**Report Date:** 10/14/2020  
**Report Number:** 2739237

**METHAMPHETAMINE CONTAMINATED PROPERTY DISCLOSURE ADVISORY**

**DISCUSSION:** According to the "Methamphetamine Contaminated Property Cleanup Act of 2005" a property owner must disclose in writing to a prospective buyer if local health officials have issued an order prohibiting the use or occupancy of a property contaminated by meth lab activity. The owner must also give a copy of the pending order to the buyer to acknowledge receipt in writing. Failure to comply with these requirements may subject an owner to, among other things, a civil penalty up to \$5,000. Aside from disclosure requirements, this new law also sets forth procedures for local authorities to deal with meth-contaminated properties, including the filing of a lien against a property until the owner cleans up the contamination or pays for the cleanup costs.

**JCP-LGS Residential Resale Property Disclosure Reports**  
**Natural Hazard Disclosure (NHD) Report**  
**For SAN BERNARDINO County**

**Property Address:** 2760 N LINDEN AVE  
RIALTO, SAN BERNARDINO COUNTY, CA 92377  
("Property")

**APN:** 0239-341-13-0000  
**Report Date:** 10/14/2020  
**Report Number:** 2739237

**MOLD ADVISORY**

**DISCUSSION:** The Buyer is hereby advised that naturally occurring molds may exist both inside and outside of any home and may not be visible to casual inspection. Persons exposed to extensive mold levels can become sensitized and develop allergies to the mold or other health problems. Extensive mold growth can damage a structure and its contents. All prospective purchasers of residential and commercial property are advised to thoroughly inspect the Property for mold. Be sure to inspect the Property inside and out for sources of excess moisture, current water leaks and evidence of past water damage.

As part of a buyer's physical inspection of the condition of a property, the buyer should consider engaging an appropriate and qualified professional to inspect and test for the presence of harmful molds and to advise the buyer of any potential risk and options available. This advisory is not a disclosure of whether harmful mold conditions exist at a property or not. No testing or inspections of any kind have been performed by The Company. Any use of this form is acknowledgement and acceptance that The Company does not disclose, warrant or indemnify mold conditions at a property in any way and is not responsible in any way for mold conditions that may exist. Information is available from the California Department of Health Services Indoor Air Quality Section fact sheet entitled, "Mold in My Home: What Do I Do?" The fact sheet is available at <https://archive.cdph.ca.gov/programs/IAQ/Pages/IndoorMold.aspx> or by calling (510) 620-3620.

The Toxic Mold Protection Act of 2001 requires that information be developed regarding the potential issues surrounding naturally occurring molds within a home. Information was written by environmental authorities for inclusion in the *Residential Environmental Hazards: A Guide for Homeowners, Buyers, Landlords and Tenants* booklet developed by the California Environmental Protection Agency and the Department of Health Services. It is found in Chapter VII of that booklet, and includes references to sources for additional information.

**For local assistance, contact your county or city Department of Health, Housing, or Environmental Health.**

**JCP-LGS Residential Resale Property Disclosure Reports**  
**Natural Hazard Disclosure (NHD) Report**  
**For SAN BERNARDINO County**

**Property Address:** 2760 N LINDEN AVE  
RIALTO, SAN BERNARDINO COUNTY, CA 92377  
("Property")

**APN:** 0239-341-13-0000  
**Report Date:** 10/14/2020  
**Report Number:** 2739237

**RADON ADVISORY**

**DISCUSSION:** For its Radon Advisory, JCP-LGS uses the updated assessment of radon exposure published in 1999 by the Lawrence Berkeley National Laboratory (LBNL) and Columbia University, under support from the U.S. Environmental Protection Agency (EPA), the National Science Foundation, and the US Department of Energy (published online at <http://www2.lbl.gov/Science-Articles/Archive/radon-risk-website.html>). Based on this recent assessment, JCP-LGS radon advisory is as follows:

**All of California's 58 counties have a predicted median annual-average living-area concentration of radon below 2.0 pCi/L (picocuries per liter of indoor air) -- which is well below the EPA's guideline level of 4 pCi/L and equivalent to the lowest hazard zone (Zone 3) on the 1993 EPA Map of Radon Zones.**

The "median concentration" means that half of the homes in a county are expected to be below this value and half to be above it. All houses contain some radon, and a few houses will contain much more than the median concentration. **The only way to accurately assess long-term exposure to radon in a specific house is through long-term testing (sampling the indoor air for a year or more).** The EPA recommends that all homes be tested for radon. Columbia University's "Radon Project" website offers help to homeowners in assessing the cost vs. benefit of testing a specific house for radon or modifying it for radon reduction (see <http://www.stat.columbia.edu/~radon/>).

**NOTE:** JCP-LGS does not use the EPA's 1993 map for advisory purposes because that map shows "short-term" radon exposure averaged by county. It was based on "screening measurements" that were intentionally designed to sample the worst-case conditions for indoor air in US homes--using spot checks (sampling for just a few days), in the poorest air quality (with sealed doors and windows), at the worst time of the year (winter), in the worst part of the house (the basement, if one was available). These short-term, winter, basement measurements are both biased and variable compared to long-term radon concentrations (averaged over a year) in the living area of a house. Long-term concentrations are a more accurate way to judge the long-term health risk from radon. For the above reasons, the EPA expressly disclaims the use of its 1993 map for determining whether any house should be tested for radon, and authorizes no other use of its map for property-specific purposes. For additional information about EPA guidelines and radon testing, see "Chapter VII--Radon", in the California Department of Real Estate's *Residential Environmental Hazards: A Guide for Homeowners, Homebuyers, Landlords and Tenants*.

**ENDANGERED SPECIES ACT ADVISORY**

**DISCUSSION:** The Federal Endangered Species Act of 1973 ("ESA"), as amended, requires that plant and animal species identified and classified ("listed") by the Federal government as "threatened" or "endangered" be protected under U.S. law. Areas of habitat considered essential to the conservation of a listed species may be designated as "critical habitat" and may require special management considerations or protection. All threatened and endangered species -- even if critical habitat is not designated for them -- are equally afforded the full range of protections available under the ESA.

In California alone, over 300 species of plants and animals have been designated under the ESA as threatened or endangered, and over 80 species have critical habitats designated for them. Most California counties are host to a dozen or more protected species and, in many cases, 10 or more species have designated critical habitats within a county.

**ADVISORY:** An awareness of threatened and endangered species and/or critical habitats is not reasonably expected to be within the actual knowledge of a seller.

No federal or state law or regulation requires a seller or seller's agent to disclose threatened or endangered species or critical habitats, or to otherwise investigate their possible existence on real property. Therefore, Buyer is advised that, prior to purchasing a vacant land parcel or other real property, Buyer should consider investigating the existence of threatened or endangered species, or designated critical habitats, on or in the vicinity of the Property which could affect the use of the Property or the success of any proposed (re)development.

**FOR MORE INFORMATION:** Complete and current information about the threatened and endangered species in California that are Federally listed in each county -- including all critical habitats designated there -- is available on the website of the U.S. Fish & Wildlife Service, the Federal authority which has enforcement responsibility for the ESA.

**U.S. Fish & Wildlife Service Endangered Species Database (TESS)**

[http://ecos.fws.gov/tess\\_public/](http://ecos.fws.gov/tess_public/)



**Natural Hazard Disclosure (NHD) Report  
For SAN BERNARDINO County**

**Property Address:** 2760 N LINDEN AVE  
RIALTO, SAN BERNARDINO COUNTY, CA 92377  
("Property")

**APN:** 0239-341-13-0000  
**Report Date:** 10/14/2020  
**Report Number:** 2739237

**ABANDONED MINES ADVISORY**

**DISCUSSION:** According to the California Department of Conservation, Office of Mine Reclamation, since the Gold Rush of 1849, tens of thousands of mines have been dug in California. Many were abandoned when they became unproductive or unprofitable. The result is that California's landscape contains many thousands of abandoned mines, which can pose health, safety, or environmental hazards on and around the mine property. Mines can present serious physical safety hazards, such as open shafts or adits (mine tunnel), and they may create the potential to contaminate surface water, groundwater, or air quality. Some abandoned mines are such massive problems as to earn a spot on the Federal Superfund environmental hazard list.

No California law requires the disclosure of abandoned mines in a real estate transaction, unless the existence of an abandoned mine is within the actual knowledge of the Seller and is deemed to be a fact material to the transaction.

The Office of Mine Reclamation (OMR) and the U.S. Geological Survey maintain a database of abandoned mines -- however, it is known to be incomplete and based on maps that are often decades out of date. Many mines are not mapped because they are on private land. The OMR warns that, **"Many old and abandoned mines are not recorded in electronic databases, and when they are, the information may not be detailed enough to accurately define, differentiate or locate the mine feature, such as a potentially hazardous vertical shaft or horizontal adit or mine waste."** (See reference below.)

**Accordingly, this Report does not contain an abandoned mines disclosure from any government database or map or any other source, in order to protect the seller from liability for non-disclosure of unrecorded abandoned mines.**

Parties concerned about the possible existence or impact of abandoned mines in the vicinity of the Property are advised to retain a State-licensed geotechnical consultant to study the site and issue a report. Other sources of information include, but are not limited to, the State Office of Mine Reclamation at (916) 323-9198 (website: <http://www.conservation.ca.gov/OMR>), and the Engineering, Planning or Building Departments in the subject City and County.

**FOR MORE INFORMATION:** For more information visit the State Office of Mine Reclamation's website at:  
[http://www.conservation.ca.gov/omr/abandoned\\_mine\\_lands/Pages/index.aspx](http://www.conservation.ca.gov/omr/abandoned_mine_lands/Pages/index.aspx)

**OIL & GAS WELL ADVISORY**

California is currently ranked fourth in the nation among oil producing states. Surface oil production is concentrated mainly in the Los Angeles Basin and Kern County, and in districts elsewhere in the state. In recent decades, real estate development has rapidly encroached into areas where oil production has occurred. Because the state's oil production has been in decline since the 1980's, thousands of oil and gas wells have been shut down or abandoned, and many of those wells are in areas where residential neighborhoods now exist.

According to the California Department of Conservation ("DOC"), to date, about 230,000 oil and gas wells have been drilled in California and around 105,000 are still in use. The majority of remaining wells have been sealed ("capped") under the supervision of the DOC's Geologic Energy Management Division (CalGEM). A smaller number have been abandoned and have no known responsible operator -- these are called "orphan" wells. The state has a special fund that pays the cost of safely capping orphan wells, however, that program is limited in its scope and progress.

**Buyer should be aware that, while the DOC database is the most comprehensive source available for California oil and gas well information, the DOC makes no warranties that the database is absolutely complete, or that reported well locations are known with absolute accuracy.**

**For More Information**

For a search of the state's databases of oil and gas wells and sites of known environmental contamination on or near the Property, please obtain the JCP-LGS Residential Environmental Report. For general information, visit the California Department of Conservation, Geologic Energy Management Division (CalGEM) at <https://www.conservation.ca.gov/CalGEM/>.

**END OF NATURAL HAZARD DISCLOSURE REPORT SECTION**  
**See Terms and Conditions at end of this Report.**

**Property Tax Disclosure Report  
For SAN BERNARDINO County**

**Property Address:** 2760 N LINDEN AVE  
RIALTO, SAN BERNARDINO COUNTY, CA 92377  
("Property")

**APN:** 0239-341-13-0000  
**Report Date:** 10/14/2020  
**Report Number:** 2739237

## California Property Tax Disclosure Report

The parties for whom this Report was prepared are the owner or transferor ("Seller") of the Residential Property ("Property") on the Report Date, the buyer or transferee ("Buyer") of the Residential Property from Seller as of the Report Date, and their respective licensed real estate agents ("Agents"). Seller, Buyer and the Agents are sometimes referred to herein as "Party" or "Parties."

### Part 1. Introduction and Summary

This Tax Report section discusses the results of an electronic search of specified government lists ("Databases") containing real property tax information concerning the Residential Property. This tax information is based on the County's Fiscal Year 2019-2020 Secured Property Tax Roll and other sources identified in the Report. To understand the information provided, please read this entire Report.

#### Summary of Property Tax Determinations

The Residential Property:	IS	IS NOT	
A.		<b>X</b>	NOT SUBJECT TO a Mello-Roos Community Facilities District. <a href="#">26</a>
B.		<b>X</b>	NOT SUBJECT TO a 1915 Bond Act District. <a href="#">26</a>
C.		<b>X</b>	NOT SUBJECT TO a Property Assessed Clean Energy (PACE) Contract. <a href="#">26</a>
D.	<b>X</b>		SUBJECT TO one or more other direct assessments. <a href="#">28</a>
E.		<b>X</b>	NOT SUBJECT TO the State Responsibility Area Fire Prevention Fee (SRA Fee is suspended until 2031 by Assembly Bill 398 of 2017). <a href="#">32</a>

Determined by First American Professional Real Estate Services, Inc.

**THIS IS A DATABASE REPORT ONLY:** The tax information in this Report only provides data derived from the County Tax Assessor's and Treasure's Databases ("Databases") identified in this Report unless specified otherwise in the Report. While JCP-LGS has made good faith efforts to report from the Databases as accurately as possible, the quality, accuracy, and currency ("Database Date") of the information contained in these Databases can vary greatly. For more information regarding a specific Database, please read Part 2 of this Report. By use of this Report, Buyer agrees this is a Report product and not an insurance policy and is subject to the Terms and Conditions attached hereto and incorporated herein.

***This Report satisfies Seller's obligations to disclose (a) Mello-Roos and 1915 Act Bond Assessments applicable to the Residential Property as required by California Civil Code Section 1102.6b, and (b) Supplemental Taxes as required by California Civil Code Section 1102.6c.***

**Property Tax Disclosure Report  
For SAN BERNARDINO County**

**Property Address:** 2760 N LINDEN AVE  
RIALTO, SAN BERNARDINO COUNTY, CA 92377  
("Property")

**APN:** 0239-341-13-0000  
**Report Date:** 10/14/2020  
**Report Number:** 2739237

**Part 2. NOTICE OF SPECIAL TAX/ASSESSMENT**

Special assessments, also referred to as direct or fixed assessments, are charges that are not based on the value of the property. These charges are levied to provide funding for services or improvements that directly benefit the property. Mello-Roos Community Facility Districts and 1915 Bond Districts are also classified as special assessments. PACE contract agreements are typically created pursuant to the Mello-Roos Act or the 1915 Bond Act. Certain special assessments may be subject to accelerated foreclosure if allowed to go delinquent.

**TO THE PROSPECTIVE PURCHASER OF THE RESIDENTIAL PROPERTY AT THE ADDRESS REFERENCED ABOVE:  
THIS IS A NOTIFICATION TO BUYER PRIOR TO PURCHASING THE RESIDENTIAL PROPERTY.**

**A. Mello-Roos Community Facilities Districts**

**This Residential Property is NOT SUBJECT to Mello-Roos Community Facilities Districts.**

**Database:** Secured Property Tax Roll

**Database Date:** FY 2019-2020

**B. 1915 Bond Act Assessment Districts**

**This Residential Property is NOT SUBJECT to 1915 Bond Assessment Districts.**

**Database:** Secured Property Tax Roll

**Database Date:** FY 2019-2020

**C. Notice of Property Assessed Clean Energy (PACE) Program**

Property assessed clean energy (PACE) programs allow property owners to finance energy efficiency, water efficiency and renewable energy projects, and qualifying seismic and wildfire safety improvements, on residential and commercial structures through a voluntary special tax assessment on the property. PACE programs are offered by many city, county and regional planning agencies, and have repayment periods ranging from 5 to 20 years however some may be longer. **PACE liens are authorized pursuant to Section 53328 of the California Government Code, (the "Mello-Roos Community Facilities Act of 1982") or California Streets & Highways Code Section 8500 (the "1915 Act") and are disclosed pursuant to Section 1102.6b of the California Civil Code.**

**WHAT THIS MEANS:** If a property owner voluntarily enters into a PACE program, a contractual assessment lien is placed on the property. The lien is repaid through installments collected on the property owner's secured county property tax bill. In certain situations the program administrator may bill the property owner directly. If the property is sold and the contractual assessment is not repaid in full, the new owner may be responsible for future assessments contributing towards repayment of the PACE contract.

**DISCLOSURES AT RESALE:** A PACE lien runs with the land. This means that the responsibility to repay the PACE lien may fall to the new owner upon transfer of the property unless the lien is paid off before closing. This fact may be material to a buyer's decision to purchase or price offered for the property. In addition, the buyer's lender may require the lien to be paid in full before closing (for certain federally backed mortgages, for example). Therefore, the property seller and his or her real estate agent may have a duty to disclose the existence of a PACE lien on the sale property.

**The Property IS NOT SUBJECT to a PACE Program Contract documented in the county's Fiscal Year 2019-2020 Secured Property Tax Roll. To discover a PACE lien on the Property executed more recently, the Buyer should read the preliminary title report and obtain and read all exceptions listed therein. Note that, in the title report, lien exceptions are named as recorded with the county; therefore, a PACE lien may be listed under a name that is not obvious.**

**D. Accelerated Foreclosure Information**

Certain assessment or bond issues may contain accelerated foreclosure liens which have priority over other real property taxes and are a legal right included as part of the security for the obligation. The issuers of such bonds are often contractually required to monitor and collect delinquent assessments quickly. Accordingly, these assessments are not subject to the five (5) year waiting period applicable to ad valorem real property taxes. If the real property is subject to such an assessment and the taxes are not paid promptly, the real property may be foreclosed upon and sold at public auction on an expedited basis. **Therefore, it is extremely important that the real property tax bill be paid on time to prevent the accelerated foreclosure.**

**E. Approved Districts Which Have Been Formed and Authorized But Are Not Yet Funded**

Certain Mello-Roos Communities Facilities Districts or 1915 Bond Act Assessment Districts may have been formed and authorized but have not yet been funded. These Districts may not appear in this Report. However, the information regarding such

**Property Tax Disclosure Report  
For SAN BERNARDINO County**

**Property Address:** 2760 N LINDEN AVE  
RIALTO, SAN BERNARDINO COUNTY, CA 92377  
("Property")

**APN:** 0239-341-13-0000  
**Report Date:** 10/14/2020  
**Report Number:** 2739237

districts may appear on your preliminary report issued by a title company. If the district is subsequently funded, the special taxes or assessments may then appear on future property tax bills for the Property.

## Property Tax Disclosure Report For SAN BERNARDINO County

**Property Address:** 2760 N LINDEN AVE  
RIALTO, SAN BERNARDINO COUNTY, CA 92377  
("Property")

**APN:** 0239-341-13-0000  
**Report Date:** 10/14/2020  
**Report Number:** 2739237

### Part 3. Current Property Tax Bill Summary

#### A. Summary of 2019-2020 Property Tax Bill

The following is a summary of Database information obtained from the SAN BERNARDINO COUNTY Secured Property Tax Roll (Database) for Tax Year 2019-2020 ("Database Date"). This summary is provided for informational purposes only. The summary includes Ad Valorem taxes which are based on the property's Assessed Value as well as other Non- Ad Valorem Direct or Special Assessments. Upon transfer of ownership, the Assessed Value may be reset to the Current Market Value or Sale Price which may result in a substantial change in the Ad Valorem taxes assessed. Please see Parts 4 and 5 of this Report for more information regarding Ad Valorem taxes and Supplemental taxes.

Total Assessed Value:	\$7,681.00
1st Installment Due 11/01/2019	\$69.71
2nd Installment Due 02/01/2020	\$69.71
Total Annual Tax Liability	\$139.42

#### General Ad Valorem Taxes

AGENCY	DESCRIPTION	AMOUNT	CONTACT PHONE
SAN BERNARDINO COUNTY GENERAL TAX	COUNTY BASE TAX RATE	\$76.81	909-387-8307
CITY OF RIALTO	BOND DEBT SERVICE	\$0.00	909-387-8307
CITY OF RIALTO	CITY OF RIALTO	\$0.00	909-387-8307
SAN BERNARDINO COMM COLLEGE	SAN BDNO COMM COLLEGE BOND	\$4.31	(909) 382-4022
RIALTO UNIFIED SCHOOL BOND	SCHOOL BONDS	\$6.51	(909) 820-7700
SAN BERNARDINO COUNTY	SCHOOL STATE REPAYMENT	\$0.00	909-387-8307
SAN BERNARDINO VALLEY MUNI WATER	SB VALLEY MUNI WTR DBT SVC	\$10.94	(909) 387-9200
	<b>TOTAL AD VALOREM TAXES</b>	<b>\$98.57</b>	

#### Direct and/or Special Assessments

AGENCY	DESCRIPTION	AMOUNT	CONTACT PHONE
COUNTY VECTOR CONTROL DIST	RIALTO VECTOR CONTROL	\$5.62	(800) 442-2283
CITY OF RIALTO	RIALTO SLD 1	\$35.23	(866) 807-6864
	<b>TOTAL DIRECT ASSESSMENTS</b>	<b>\$40.85</b>	

#### B. Available Senior Citizen Exemptions

Certain districts that levy special taxes or assessments may offer exemptions to Senior Citizens. These exemptions can result in substantial savings to qualified tax payers. The filing of an application along with annual renewal may be required. Below is the contact information for requesting details on filing exemptions for districts that may offer a Senior Citizen Exemption. Additional Direct Assessment Districts may offer exemptions. Therefore you may want to contact the districts to determine their policy on Senior Citizen Exemptions.

No Senior Citizen Exemptions listed as of the most recent update from the County.  
See Part 4B for additional information on other exemptions that may be available to Buyer.



**Property Tax Disclosure Report  
For SAN BERNARDINO County**

**Property Address:** 2760 N LINDEN AVE  
RIALTO, SAN BERNARDINO COUNTY, CA 92377  
("Property")

**APN:** 0239-341-13-0000  
**Report Date:** 10/14/2020  
**Report Number:** 2739237

## Part 4. Estimating Property Taxes After the Sale

Instantly and securely calculate estimated property taxes and supplemental taxes on our website (or manually calculate them below):

<https://orderform.fanhd.com/Order/TaxCalcForm?token=FJbpkUg4zDMr7n8Fu4E%2bWK1BNFL930984AaPMEeUY3RDYhBxm9lRAmne6blxBQr6YtrJnPsdIWajlkgXe%2fG9%2bXqS5cpXjOLVJbGyYlJDpjpg%3d>

### A. Calculating Property Taxes After Sale (ESTIMATE ONLY)

#### PROPERTY TAX ESTIMATOR

The following calculation method is provided to assist Buyer in estimating the approximate amount of property tax charges that the Residential Property may be subject to for the upcoming tax year based on the assessed valuation being equal to the sales price. The amount derived is only an estimate and is not a substitute for a tax bill from the County, nor does it anticipate new property tax charges, fees or other changes in the property tax rates for future tax years.

1	Estimated Sales Price.....	• 1	\$	
2	Estimated Ad Valorem Tax Rate.....	• 2		<b>0.01283</b>
3	Multiply line 1 by line 2. This is your Estimated Ad Valorem Tax.....	• 3	\$	
4	Direct Assessments including Mello Roos Special Taxes, 1915 Bond Act Assessments or PACE Assessments applicable.....	• 4	\$	<b>40.85</b>
5	Add lines 3 and 4. Total Estimated Annual Tax Amount After Sale.....	• 5	\$	

The information in this subparagraph A is an estimate only. The purpose of this "ESTIMATOR" is to assist Buyer in planning for property taxes which will be applicable after the Sale Date. This "ESTIMATOR" requires the Buyer's projection of the purchase price of the Residential Property. Please note that potential exemptions and exclusions are not reflected in this estimate. **Additionally, undeveloped or recently developed properties may be subject to additional Direct Assessments not included in this estimate. JCP-LGS is not responsible or liable for any losses, liabilities or damages resulting from use of this Property Tax Estimator.**

### B. Exemptions & Exclusions to Ad Valorem Taxes

California law provides certain exemptions from reassessments. The following is a list of common exemptions which may be available:

- Homeowner exemption (California Constitution Art XIII, §3 & R&T Code §218)
- Honorably discharged veterans (California Constitution Art XIII, §3 & R&T Code §205)
- Disabled veterans (California Constitution Art XIII, §4 & R&T Code §205)

California law also provides certain exclusions from reassessment. The following is a list of common exclusions which may be available:

- Persons over 55 years of age (R&T Code § 69.5)
- Severely and permanently disable persons (R&T Code § 69.5(a))
- Transfers between parents and children and grandparents and grandchildren (R&T Code § 63.1)
- Transfers into revocable trusts (R&T Code § 62)
- Interspousal transfers (R&T Code § 63)
- Improvements for seismic retrofitting (R&T Code § 74.5)
- Improvements for disabled access (R&T Code § 74.3)
- Replacement of property damaged or destroyed by disaster (R&T Code § 69)

In order to determine if Buyer may qualify for any exemptions or exclusions or to obtain a comprehensive list of available exemptions and exclusions, please contact the county tax assessor's office (909-387-8307) or visit the county website at <https://sbcountyarc.org/service-category/assessor/>. Additional information is also available on the website for the California Board of Equalization at [www.boe.ca.gov](http://www.boe.ca.gov)

**Property Tax Disclosure Report  
For SAN BERNARDINO County**

**Property Address:** 2760 N LINDEN AVE  
RIALTO, SAN BERNARDINO COUNTY, CA 92377  
("Property")

**APN:** 0239-341-13-0000  
**Report Date:** 10/14/2020  
**Report Number:** 2739237

## **Part 5. Supplemental Property Tax Information**

### **A. General Information Regarding Supplemental Taxes**

California law mandates the county assessor to reappraise real property upon a change in ownership or completion of new construction. The assessor's office issues a supplemental assessment which reflects the difference between the prior assessed value and the new assessment. This value is prorated based on the number of months remaining in the fiscal tax year which ends June 30.

Notices of the supplemental assessment are mailed out to the property owners prior to the issuance of the supplemental tax bill or refund if the value is reduced. The taxes or refund based on the supplemental assessment are in addition to the regular annual tax bill.

The supplemental tax will be due from the current owner in addition to the regular tax assessment. Accordingly for the first year of ownership, Buyer should plan for this additional payment.

### **B. Supplemental Property Tax Disclosure**

The following notice is mandated by California Civil Code Section 1102.6c:

#### **NOTICE OF YOUR "SUPPLEMENTAL" PROPERTY TAX BILL**

**"California property tax law requires the Assessor to revalue real property at the time the ownership of the property changes. Because of this law, you may receive one or two supplemental tax bills, depending on when your loan closes.**

**The supplemental tax bills are not mailed to your lender. If you have arranged for your property tax payments to be paid through an impound account, the supplemental tax bills will not be paid by your lender. It is your responsibility to pay these supplemental bills directly to the Tax Collector.**

**If you have any question concerning this matter, please call your local Tax Assessor or Collector's Office."**

SAN BERNARDINO County Assessor

Phone: 909-387-8307

Website: <https://sbcountyarc.org/service-category/assessor/>

**Property Tax Disclosure Report  
For SAN BERNARDINO County**

**Property Address:** 2760 N LINDEN AVE  
RIALTO, SAN BERNARDINO COUNTY, CA 92377  
("Property")

**APN:** 0239-341-13-0000  
**Report Date:** 10/14/2020  
**Report Number:** 2739237

**C. Calculating Supplemental Taxes After Sale (ESTIMATE ONLY)**

Instantly and securely calculate estimated property taxes and supplemental taxes on our website (or manually calculate them below):

<https://orderform.fanhd.com/Order/TaxCalcForm?token=FJbpkUg4zDMr7n8Fu4E%2bWK1BNFL930984AaPMEeUY3RDYhBxm9lRAmne6blxBQr6YtrJnPsdIWajlkgXe%2fG9%2bXqS5cpXjOLVJbGyYIJDpjg%3d>

**SUPPLEMENTAL TAX ESTIMATOR**

The following schedule is provided to estimate the potential amount of the supplemental taxes on a given property and does NOT include the amount of the regular annual ad valorem property tax. The following calculation provides an estimate of the supplemental property taxes that can be expected during the first year of ownership, and should be used for planning purposes only.

- |   |   |     |    |          |
|---|---|-----|----|----------|
| 1 | Estimated Sales Price.....  | • 1 | \$ | _____    |
| 2 | Estimated Current Assessed Value.....   | • 2 | \$ | 7,681.00 |
| 3 | Subtract line 2 from line 1.<br>Estimated Supplemental Assessed Value.....  | • 3 | \$ | _____    |
| 4 | Multiply line 3 by 0.01283 (the Estimated Ad Valorem Tax Rate for the Residential Property).<br>Estimated Full-Year <b>Supplemental</b> Tax Obligation..... | • 4 | \$ | _____    |

**If the Sale Date for the Residential Property falls during the months of January through May, Buyer will receive TWO supplemental tax bills: (a) one for the current partial tax year; and (b) one for the next full tax year. The supplemental taxes can be estimated by completing lines 5 through 8 below:**

- |   |   |     |          |
|---|---|-----|----------|
| 5 | Enter the Month-of-Sale Factor from <b>TABLE 1</b> below.....           | • 5 | _____    |
| 6 | Multiply line 4 by line 5.<br>Estimated Supplemental Tax Bill # 1.....  | • 6 | \$ _____ |
| 7 | Enter the amount on line 4.<br>Estimated Supplemental Tax Bill # 2..... | • 7 | \$ _____ |
| 8 | Add lines 6 and 7. Total estimated Supplemental Tax Bill.....           | • 8 | \$ _____ |

**If the Sale Date for the Residential Property falls during the months of June through December, Buyer will receive ONE supplemental tax bill. The supplemental tax can be estimated by completing lines 9 and 10 below:**

- |    |   |      |          |
|----|---|------|----------|
| 9  | Enter the Month-of-Sale Factor from <b>TABLE 2</b> below.....         | • 9  | _____    |
| 10 | Multiply line 4 by line 9. Total estimated Supplemental Tax Bill..... | • 10 | \$ _____ |

**TABLE 1. Month-of-Sale Factor**

<b>Jan</b>	0.4167
<b>Feb</b>	0.3333
<b>Mar</b>	0.2500
<b>Apr</b>	0.1667
<b>May</b>	0.0833

**TABLE 2. Month-of-Sale Factor**

<b>Jun</b>	1.0000
<b>Jul</b>	0.9167
<b>Aug</b>	0.8333
<b>Sept</b>	0.7500
<b>Oct</b>	0.6667
<b>Nov</b>	0.5833
<b>Dec</b>	0.5000

The information in this subparagraph C is an estimate only. The purpose of this "ESTIMATOR" is to assist Buyer in planning for the supplemental taxes. The estimated supplemental tax is not a substitute for the supplemental bill and may not be relied upon as such. This "ESTIMATOR" requires the Buyer's projection of the purchase price of the Residential Property as well as month in which the transaction will be consummated. Please note that potential exemptions and exclusions are not reflected in these estimations. JCP-LGS is not responsible or liable for any losses, liabilities or damages resulting from use of this Supplemental Tax Estimator.

**Property Tax Disclosure Report  
For SAN BERNARDINO County**

**Property Address:** 2760 N LINDEN AVE  
RIALTO, SAN BERNARDINO COUNTY, CA 92377  
("Property")

**APN:** 0239-341-13-0000  
**Report Date:** 10/14/2020  
**Report Number:** 2739237

## **Part 6. State Responsibility Area Fire Prevention Fee**

In 2011, the California Legislature and Governor enacted a "Fire Prevention Fee" on habitable structures in the State's wildland fire responsibility area ("SRA"). The yearly fee, levied on property owners, paid for various activities to prevent and suppress wildfires in the SRA, and was most recently at the rate of \$152.33 per habitable structure on the property.

**Effective July 1, 2017, as authorized by Assembly Bill 398 and signed by the Governor, that fire prevention fee is suspended until 2031.**

The fire prevention activities supported by the fee will continue, but instead will be funded through a different State program – one aimed at curbing industrial emissions of carbon dioxide (also known as California's "cap-and-trade" program). For more information, please refer to the text of the Assembly bill at the following link:

[http://leginfo.ca.gov/faces/billNavClient.xhtml?bill\\_id=20170180AB398](http://leginfo.ca.gov/faces/billNavClient.xhtml?bill_id=20170180AB398)

## **Part 7. Private Transfer Fee Advisory**

**Private Transfer Fee.** This is a fee imposed by a private entity such as a property developer, home builder, or homeowner association, when a property within a certain type of subdivision is sold or transferred. (It is commonly known as a "Private Transfer Tax".) It is NOT the same as a city or county Documentary Transfer Tax. A Private Transfer Fee may apply in addition to government Documentary Transfer Taxes that are due upon sale or transfer of the Property.

**Transfer Fee Defined.** California Civil Code Section 1098 defines a "Transfer Fee".

**Effective January 1, 2008, if the payment of any Transfer Fee is required in the sale or transfer of the Property, Civil Code Section 1102.6e requires Seller to notify Buyer of the existence of the fee and to disclose certain specific information about the fee.**

**How to Determine the Existence of a Transfer Fee.** If a Transfer Fee does exist affecting the Property, the document creating the fee may be on file with the County Recorder as a notice recorded against the Property and should be disclosed in the preliminary (title) report on the Property. However, the preliminary (title) report will merely disclose the existence of the documents affecting title, not the content of the documents. The title of a document may also not be sufficient to disclose that a Transfer Fee is included in its terms. Accordingly Seller should (a) request the title company which issued the preliminary (title) report to provide copies of the documents shown as "exceptions," and (b) review each document to determine if it contains a Transfer Fee.

**Parties are advised that documents regarding any Transfer Fee should be obtained early in the sale process in order to avoid delays in the transaction process and to ensure full disclosure as required by law.**

**To determine if the Property is subject to a Transfer Fee, OBTAIN COPIES OF ALL OF THE EXCEPTIONS LISTED ON THE PRELIMINARY (TITLE) REPORT FROM THE TITLE COMPANY AND READ THEM TO DETERMINE IF ANY TRANSFER FEES ARE APPLICABLE.**

**END OF TAX DISCLOSURE REPORT SECTION**  
**See Terms and Conditions at end of this Report.**

**Property Address:** 2760 N LINDEN AVE  
RIALTO, SAN BERNARDINO COUNTY, CA 92377  
("Property")

**APN:** 0239-341-13-0000  
**Report Date:** 10/14/2020  
**Report Number:** 2739237

## TERMS and CONDITIONS

ACCEPTANCE OR USE OF THE WEBSITE, CUSTOMER SERVICE, OR ANY REPORT CONSTITUTES APPROVAL AND ACCEPTANCE OF THESE TERMS AND CONDITIONS AS STATED HEREIN.

The Website (defined below), Customer Service (defined below) and any Report (defined below) are subject to each of the following Terms and Conditions. Any User (defined below) accessing, using, or reviewing the Website, Customer Service, or any Report, including any portion thereof, agrees that the Website, Customer Service and Reports are subject to the following Terms and Conditions, and such User agrees to be bound by these Terms and Conditions, regardless of whether the User ordered a Report on the Website or over the telephone through Customer Service, and regardless of whether the User paid for the Report. Use of any kind of the Website or a Report by any User constitutes acceptance of these Terms and Conditions, which are incorporated by this reference into every Report.

### A Report is not an insurance policy.

A Report is made for the Property (defined below) and solely for the transaction for which it was originally purchased ("Transaction"). The Property shall not include any property beyond the boundaries of the real property described in a Report. The Property shall not include any structures (whether located on the Property, or not), easements, or any right, title, interest, estate, or easement in any abutting streets, roads, alleys, lanes, ways, or waterways.

**IMPORTANT NOTICE:** Transferor(s) and transferee(s) shall read a complete Report in its entirety before the close of escrow. A "Signature Page" or "Summary Pages" document may be included in the electronic delivery of the Report. Those documents do not replace the complete Report or remove the need to read a complete Report, and do not remove the requirement to disclose. The Signature Page and Summary Pages documents are subject to these Terms and Conditions.

### 1) Definitions.

- a. **"Company"** shall mean First American Professional Real Estate Services, Inc., a California corporation, operating through its Natural Hazard Disclosure division, "JCP-LGS."
- b. **"Company Content"** shall mean all editorial content, graphics, data, and information contained in the Report or on the Website, any portion thereof, including the selection, coordination, and arrangement of the editorial content, graphics, data, and information on the Website, and the hierarchy of the Website.
- c. **"Customer Service"** shall mean Company's customer service telephone service department or representatives.
- d. **"User"** shall mean any person or entity.
- e. **"Property"** shall mean the real property specifically described in a Report.
- f. **"Report"** shall mean any residential disclosure report prepared by the Company, including but not limited to a JCP-LGS Residential Property Disclosure Report, available through the Website or Customer Service.
- g. **"Website"** shall mean the www.fanhd.com website, the www.disclosures.com website, the www.reodisclosure.com website, and any other individual sites as may be added to, or available through, the foregoing or any other Company website, including, without limitation, the data and computer code, underlying, contained on, or transmitted from the Website, a Report, and the Company Content. Any reference herein to the Website shall be to each individual item and also to the Website as a whole.

2) **No Third Party Reliance on Any Report.** Only the transferor(s) and transferee(s), and their agents/brokers, if any, involved in the Transaction (collectively, the "Recipients") may use and rely on a Report and only after they have paid in full for the Report. While disclosures made on the Natural Hazard Disclosure Statement in a Report may indicate certain risks to the Property, the disclosures are only "...between the transferor, the transferor's agents, and the transferee, and shall not be used by any other party, including, but not limited to, insurance companies, lenders, or governmental agencies, for any purpose." Cal. Civil Code section 1103.2, subdivision (g).

3) **Seller and Seller's Agent's Responsibility of Full Disclosure.** Recipients are obligated to make disclosures, and always disclose material facts, that are within their actual knowledge.

4) **Scope of Any Report.** A Report is limited to determining whether the Property is located in those specified natural hazard zones and property tax districts, and in proximity to those specified environmental sites (depending on the report product ordered), as defined in the Report. The Report is not a geologic report or a land survey, and no site inspection has been made in producing the Report. Company makes no determination, expresses no opinion or view, and assumes no responsibility in any Report concerning the right, entitlement, or ability to develop or improve the Property. Company has no information concerning whether the Property can be developed or improved. No determination is made, and no opinion is expressed or intended by any Report concerning structures or soils on or outside of the Property, including, without limitation, habitability of structures or the Property, suitability of the Property for construction or improvement, potential for soil settlement, drainage, soil subsidence, or other soil or site conditions. The Recipient(s) is advised to consult the local Planning Department to determine whether factors beyond the scope of any Report may limit the transferee(s) ability to use or improve the Property.

The Report is not a title report, and no determination is made and no opinion is expressed, or intended, by the Report as to title to the Property or liens against the Property, recorded or otherwise, or whether the Property is comprised of legal lots in conformance with the California Subdivision Map Act or local ordinances. The Report is not a property inspection report, and no determination is made and no opinion is expressed, or intended, by the Report concerning architectural, structural, mechanical, engineering, or legal matters, or the marketability or value of the Property. Company has not conducted any testing or physical or visual examination or inspection of the Property, nor is the Report a substitute for any such testing, physical or visual examination, or inspection.

5) **Tax and Environmental Disclosures (if included in Report).** No determination is made and no opinion is expressed, or intended, by a Report concerning the existence of property tax liabilities, or the existence of hazardous or toxic materials or substances, or any other defects, on, under, or in proximity to the Property, unless specifically described in the Report.

6) **Company Database Updates.** To the extent databases are used in preparing a Report, each database is updated by the responsible agency at various intervals. Updates for a database are determined by the responsible agency and may be made at any time and without notice. The Company maintains an update schedule

# JCP-LGS Residential Resale Property Disclosure Reports Terms and Conditions

**Property Address:** 2760 N LINDEN AVE  
RIALTO, SAN BERNARDINO COUNTY, CA 92377  
("Property")

**APN:** 0239-341-13-0000  
**Report Date:** 10/14/2020  
**Report Number:** 2739237

and makes reasonable efforts to use updated information. For these reasons, the Company reports information as of the date when the database was last updated by the Company. That date is specified as the "Database Date" for each database. The Tax Report discloses Mello Roos Community Facilities Districts, 1915 Bond Act Assessments and PACE assessments documented in the county's Fiscal Year 2019-2020 annual secured property tax roll. The Report may disclose PACE contracts where PACE taxes were first assessed or liens were recorded after the Fiscal Year 2019-2020 secured property tax roll, where recordation data is available to JCP-LGS. To discover a PACE lien on the Property executed more recently, the buyer should read the preliminary title report and obtain and read all exceptions listed therein. Note that, in the title report, lien exceptions are named as recorded with the county; therefore, a PACE lien may be listed under a name that is not obvious.

- 7) **Statutory and Additional Disclosures, Advisories, and Local Addenda (if included in Report).** No determination is made and no opinion is expressed, or intended, by a Report concerning the need to purchase earthquake or flood insurance for the Property. In preparing the Report, Company accurately reported on information contained in public maps and databases ("Government Records"). Company reviewed and relied upon those Government Records specifically identified and described in the Report. Company has not reviewed or relied upon any Government Records that are not specifically identified in the Report. Company also has not reviewed any plat maps, survey maps, surveyor maps, assessor maps, assessor parcel maps, developer maps, or engineering maps, whether or not such maps have been recorded. No determination is made and no opinion is expressed, or intended, by the Report concerning any matters identified in Government Records that were not reviewed by Company. Local Addenda, where applicable, are included "AS IS" as an accommodation to the local real estate board that provided the content; Company assumes no responsibility for the accuracy of any information included in the Local Addenda.
- 8) **FEMA Flood Determination Certificate (if accompanying the Report).** No determination is made, and no opinion is expressed or intended by a Report concerning the requirement for or cost of flood insurance on the Property. Recipient(s) understands that a lender may require flood insurance to secure its loan collateral independent of whether FEMA may require flood insurance under the National Flood Insurance Program on a federally backed mortgage. The FEMA Flood Determination Certificate ("Flood Certificate") that may accompany the Report, is produced by a third-party expert certified by FEMA to provide Flood Certificates. Company assumes no liability for errors in that third-party flood determination.
- 9) **Changes to Government Record after Report Date.** A Report is issued as of the Report Date identified in the Report. Company shall have no obligation to advise any Recipient of any information learned or obtained after the Report Date even if such information would modify or otherwise affect the Report. Subsequent to Company's acquisition of Government Records, changes may be made to said Government Records, and Company is not responsible for advising Recipients of any changes. Company will update the Report upon request and at no charge during the transaction process for which the Report was issued, but not to exceed one year from the date of the Report. Likewise, Company is not liable for any impact on the Property that any change to the Government Records may have.
- 10) **Government Record Sources.** Company relies upon the Government Records specifically identified in a Report without conducting an independent investigation of their accuracy. Company assumes no responsibility for the accuracy of the Government Records identified in the Report. Company makes no warranty or representation of any kind, express or implied, with respect to the Report. Company expressly disclaims and excludes any and all other express and implied warranties, including, without limitation, warranties of merchantability or fitness for a particular purpose. The Company Report is "AS IS."

## 11) Not for Credit Purposes.

The Company Content available in any Report has not been collected for credit purposes and is not intended to be indicative of any consumer's credit worthiness, credit standing, credit capacity, or other characteristics listed in Section 1681(a) of the Fair Credit Reporting Act, 15 U.S.C. § 1681 et seq. The Report shall not be used:

- a. as a factor in establishing an individual's eligibility for credit or insurance,
- b. in connection with underwriting individual insurance,
- c. in evaluating an individual for employment purposes,
- d. in connection with a determination of an individual's eligibility for a license or other benefit granted by a governmental authority,
- e. in any way that would cause the Report to constitute a "consumer report" under the Fair Credit Reporting Act, 15 U.S.C. § 1681 et seq., or
- f. in any other manner that would cause such use of the Report to be construed as a consumer report by any pertinent governmental authority.

## 12) Limitation of Company's Liability

- a. Company is not responsible for:
  - Any inaccuracies or incompleteness of the information in the Public Records.
  - Inaccurate address information provided for the Property.
  - Any other information not contained in the Public Records as of the Report Date.
  - Any information which would be disclosed by a physical inspection of the Property.
  - Any information known by you, a Recipient, a User, the transferor or transferee, or their agents/brokers.
  - The health or risk to humans or animals that may be associated with any of the disclosed hazards.
  - The costs of investigating or remediating any of the disclosed hazards.
- b. In no event shall Company or its data suppliers be liable for any damages resulting from the inability or failure to access or interface with the Website or Customer Service.
- c. Except as otherwise expressly set forth in these Terms and Conditions, Company's total liability and responsibility to all Users accessing the Website, Customer Service, or any Report collectively for any and all liabilities, causes of action, claim or claims, including, but not limited to, claims for breach of contract or negligence, shall be for actual proven damages only caused directly by Company's error. In no event shall Company's total liability exceed the difference between the amount actually paid for the Property and the fair market value on the date of the disclosure, as measured by a retrospective appraisal performed by - an MAI Designated Member of the Appraisal Institute specializing in the subject property category (e.g., residential, commercial or vacant land). Company expressly disclaims any liability for Recipients' or Users' indirect, incidental and/or consequential damages, including, without limitation, lost profits, even if such damages are foreseeable, and you, User and Recipients hereby waive and release any right to assert a claim against Company for such amounts.



# JCP-LGS Residential Resale Property Disclosure Reports

## Terms and Conditions

**Property Address:** 2760 N LINDEN AVE  
RIALTO, SAN BERNARDINO COUNTY, CA 92377  
("Property")

**APN:** 0239-341-13-0000  
**Report Date:** 10/14/2020  
**Report Number:** 2739237

- d. **Product and Service Claims.** User shall provide prompt notice to Company, and a reasonable opportunity to cure, any known error, omission or mistake that may result in a claim on products or services provided under these Terms and Conditions, prior to making a claim against the Company. In addition, User shall use their best efforts to mitigate any losses resulting from any products or services provided pursuant to these Terms and Conditions. If User does not perform according to the requirements of this section, Company will not be liable. User also must provide sufficient documentation, as deemed appropriate by Company, to evidence any out-of-pocket, actual monetary loss.
- e. **Links.** Where Company provides hypertext links to other Internet websites on the Website, or in any Report, the Company does so for informational purposes only, and such links are not endorsements by Company of any products or services on such sites. Company shall not accept, and shall not incur, any liability for such products or services and makes no endorsement or approval of the same.

**13) Reporting of Risk Elements for Condominium Projects, Planned Unit Developments, and Other Properties with Common or Undivided Interests ("Common Interests")** Unless otherwise noted, this report is based solely on the real Property referenced by the Property's Assessor's Parcel Number ("APN"). An APN whose boundary does not include all Common Interests associated with the parcel will generate a report which does not identify the natural hazards relating to the Common Interests that extend beyond the APN parcel boundary. Accordingly, it is imperative that you consult with the property's homeowners association(s) to determine those risks.

**14) User Account and Information.**

- a. To obtain and use a Report, User must order the Report through the Website or over the telephone through Customer Service or by email. To order the Report online, User must register for an account on the Website and provide information required in the Website registration form. As part of that registration, User agrees to accurately furnish all contact and other information requested by Company and notify Company immediately of any change in the information.
- b. Company reserves the right to refuse or reject any request to create an account for any or no reason at Company's sole discretion. User solely is responsible for their account, contact information and other information made available through User's account or otherwise via the Website. User shall use reasonable care to protect the confidentiality of their account log-in information and will not share it with any other person or entity. User will be entirely responsible for the conduct of any person using their account information to access the Website, Customer Service, or any Report.
- c. User only shall access the Website using a password or other security mechanism to prevent unauthorized access. Sharing of User access is prohibited, and any automation of accessing information is strictly prohibited unless expressly authorized in writing by Company. It is User's sole responsibility to maintain the confidentiality of all usernames and passwords, and User shall be responsible for all charges relating to the use of said usernames and passwords whether or not authorized by User. In no event shall User use the Website, Customer Service, or any Report for illegal purposes or in any manner that is defamatory, libelous, unlawfully threatening or unlawfully harassing, or that otherwise violates any federal, state or local statute, law or regulation, for debt collection, skip tracing, or electronic telephone directory assistance or otherwise breaches or violates these Terms and Conditions.

**15) Confidentiality.** User acknowledges that the Website and any Report contain valuable commercial products, the development of which has involved the expenditure of substantial time and money. User shall take appropriate measures and shall initiate strict security measures to prevent the accidental or otherwise unauthorized use or release of any and all proprietary and confidential information of the Company and any third parties associated with the Report or provided through the Website or Customer Service.

**16) License to Use Website, Customer Service, and Any Report.** Subject to User's compliance with these Terms and Conditions, Company grants User a limited, non-exclusive, revocable, non-assignable, personal and non-transferable license to access and make use of the Website, Customer Service, and any Report solely for the purposes specified in these Terms and Conditions, and not for any other purpose whatsoever. The foregoing license does not include any resale or commercial use of the Website, Customer Service, Report, or Company Content obtained from the Website, Customer Service, or any Report. The Website, Report, and the Company Content therein, and any portion thereof, may not be reproduced, duplicated, copied, sold, resold, visited, or otherwise exploited for any commercial purposes without Company's express written consent. This license does not include any derivative use of this Website or the Report, or any Company Content therein nor any use of data mining, robots, or similar data gathering and extraction tools. User may not frame or utilize framing techniques to enclose any trademark, logo, or other proprietary information (including images, text, page layout, or form) of the Website, the Report or the Company Content without express written consent of the Company. User may not use any meta tags or any other "hidden text" or trademarks without the express written consent of the Company. Any unauthorized use terminates the permission or license granted by the Company.

**17) Use of the Website, Customer Service, and Report.** User acknowledges and agrees that their use of and access to the Website, Customer Service, and any Report may be logged and monitored. User agrees that Company controls the terms of all access to, and use of, the Website (including any upgrades, modifications or updates thereto), Customer Service, and all products, services, and materials contained therein that are delivered by means of the Website, including the Reports, and all third-party products and information and data that may be included therein. The Company reserves the right to revise or alter the Website, Customer Service, the Reports, and the provisions of these Terms and Conditions at any time, in its sole discretion. By accessing or using the Website, Customer Service, or a Report, User agrees not to use the Website, Customer Service, or Report in any way that:

- is unlawful, fraudulent, tortious, or in any other manner Company deems in its sole discretion to be inappropriate or impermissible;
- may harm Company, any Recipient, or any other person or entity;
- violates or infringes the rights of the Company or any third party;
- gains or tries to gain unauthorized access to the Website, Customer Service, Company's computers and networks, any Report, or the Company's data, or that otherwise modifies or interferes with the permitted use or operation of the Website or Customer Service, or the permitted use of the Report;
- imposes an unreasonable or disproportionately large load on Company's infrastructure, including but not limited to transmitting spam or using other unsolicited communications or techniques;
- repurposes, copies, excerpts, disassembles, decompiles, manipulates, alters, damages, or deletes any Company Content or removes or modifies any copyright or other intellectual property notices that appear on the Website or any Report;
- contains computer viruses or other disruptive, damaging or harmful files or programs; or
- otherwise violates these Terms and Conditions, or any other terms, guidelines, or policies provided by Company.

In addition, User represents and warrants that:

# JCP-LGS Residential Resale Property Disclosure Reports

## Terms and Conditions

**Property Address:** 2760 N LINDEN AVE  
RIALTO, SAN BERNARDINO COUNTY, CA 92377  
("Property")

**APN:** 0239-341-13-0000  
**Report Date:** 10/14/2020  
**Report Number:** 2739237

- the information and other content that User provides using the Website, Customer Service, or Report does not infringe, violate, misappropriate or otherwise conflict with the rights of the Company or any third party; complies with all applicable local, state, national, and other laws, rules and regulations; and does not violate these Terms and Conditions;
- User will use their true legal name, address, electronic mail address, and only provide true, accurate and complete information on the Website;
- User will not impersonate another party or misrepresent or falsify their affiliation with another person, such as by using another user name, password or other account information or another name, likeness, image or photograph, or using fictitious personal or address information;
- User is at least 18 years of age, or the legal age of majority where User resides;
- User has all requisite rights and authority to use the Website, Customer Service, and Report, and to enter into these Terms and Conditions; and
- the performance of User's obligations under these Terms and Conditions will not violate, conflict with, or result in a default under any other agreement, including confidentiality agreements between User and third parties.

**18) User Content.** User hereby represents and warrants that any content that they upload to the Website, if permitted, or content that User uses in connection with any Report shall not be used in any manner that is defamatory, libelous, unlawfully threatening or unlawfully harassing, and does not and shall not infringe upon or misappropriate any rights, including, without limitation, intellectual property rights, proprietary rights or confidentiality rights, or rights of publicity or privacy of any third parties or the Company, and that such content is free of worms, viruses, Trojan Horses and other disabling code. For the avoidance of doubt, "content" as used in this section in connection with the User shall be construed broadly so as to include, but not be limited to, all materials, documents, data, information or other materials that User may upload to the Website or use in connection with any Report.

**19) Intellectual Property.**

- Unless otherwise provided, Company owns the copyrights, trademarks, service marks, and trade dress rights to all materials and content displayed on and from the Website and any Report (including visual interfaces, interactive features, graphics, designs, databases and their data, computer code, products, software and all other elements and components of the Website and Report). User may not reproduce, repurpose, modify, excerpt, create derivative works, display, frame, perform, publish, distribute, sell, disseminate, transmit, broadcast, sell, or circulate any such materials or content, including, without limitation, the Report or Website, or the contents thereof, to any third party (including displaying or distributing the material using a third-party website) without Company's prior written consent.
- Copyrights.** The Website and any Report are owned and copyrighted by Company. No ownership rights are being granted to User by these Terms and Conditions. Subject to the limited license provided in these Terms and Conditions, Company reserves all rights in and to Website and any Report, including, but not limited to, the exclusive rights under copyright and other intellectual property and the right to grant further licenses. User shall only use the Website as specifically stated herein. Company and its licensors reserve and retain all copyright, intellectual property and other proprietary rights in and to Company Content, including without limitation, all rights in any public information that may have been gathered, including as a compilation. All Company Content is protected by U.S. and/or international copyright laws, international treaties and/or other applicable laws. Unauthorized use of the Website or the Company Content is strictly prohibited and may subject User to prosecution. User acknowledges that all information accessed through the Website and any Report are proprietary information of Company, including any third-party suppliers (including, without limitation, real property ownership information) under copyright, and have been furnished to User in trust. Any revision, republication and re-use of Company Content or the Website for any purpose are strictly prohibited in whole or in part. Except as expressly permitted herein, the materials from the Website including, but not limited to, Company Content may be used solely for limited non-commercial informational purposes only as necessary to do business with the Company or for evaluating or purchasing Company's products and services. Except for downloading as may be expressly authorized by Company within specific portions of the Website, the Company Content may not be reproduced, licensed, copied, displayed, published, sold, modified, transmitted or distributed without the Company's prior written permission which may be withheld in Company's sole discretion. Linking to and/or framing the Website is strictly prohibited unless Company expressly consents in writing to such a link or frame, and User enters into a further agreement for such linking to and/or framings. Any person or entity wishing to establish a link to the Website, frame the Website, or request the Company's consent to other uses of the Website or Company Content, may send their request by e-mail to the Company Webmaster. All other uses of the Website and/or Company Content not expressly addressed in these Terms and Conditions are strictly prohibited.
- Trademarks.** Company and/or its parent company, subsidiaries or affiliates own several trademarks and service marks that are used in connection with, among other things, the Website and any Report, including, but not limited to, First American, JCP-LGS, the Eagle logo ® ("Company Marks"). Any use of the Company Marks requires prior approval in writing by the Company which may be withheld in Company's sole discretion. The "look and feel" of the Website and any Report, and the contents thereof, including, without limitation, the Company Content, such as the color combinations, buttons, layout, and other graphical elements are protected by applicable U.S. and international intellectual property laws, including, without limitation, trademark, copyright and trade dress laws. Nothing contained herein shall constitute a license (either express or implied) for User to use any of the Company Marks or trade dress, including the elements that constitute the "look and feel" of the Website and any Report.
- Company retains all rights that are not otherwise expressly granted in these Terms and Conditions.
- At Company's request, User shall return or delete any and all Website or Report content or portion thereof in their possession.

**20)** In the event of a dispute involving a violation of Paragraphs 15, 16, 17, 18, or 19 of these Terms and Conditions, such dispute shall not be subject to the Small Claims or Arbitration provisions set forth in Paragraph 23 below. In any litigation to stop a violation of those Paragraphs, the prevailing party shall be entitled to recover its reasonable attorneys' fees, expert fees and costs.

**21) Pricings/Billing and Payment Processing.** Company reserves the right to change any Report pricing, including whether a Report is billed for, at any time without notice. To the extent applicable, charges or fees for any Report will be accumulated under the licensee account number and will be invoiced either through escrow or directly to licensee, depending upon how licensee sets up their account.

In the event that any credit card payments are processed by a third-party card processing company, such third-party card processing company will be contractually required by Company to use commercially adequate security and confidentiality measures. That agreement requires the card processing company to use adequate security and confidentiality measures to protect User's payment information. All payment information that User provides through the Website will be transmitted directly to the card processing company over a secure connection. Company will not record User's credit card number, expiration date, or CVV number. However, this information may be stored by the card processing company in the normal course of its business, or as required or authorized by law, statute, regulation, or Payment Card Industry standard.

## JCP-LGS Residential Resale Property Disclosure Reports Terms and Conditions

**Property Address:** 2760 N LINDEN AVE  
RIALTO, SAN BERNARDINO COUNTY, CA 92377  
("Property")

**APN:** 0239-341-13-0000  
**Report Date:** 10/14/2020  
**Report Number:** 2739237

- 22) **Governing Law.** These Terms and Conditions, and a User's use of the Website, Customer Service, or any Report shall be governed by, and construed in accordance with, the laws of the State of California.
- 23) **Small Claims or Arbitration.** This provision constitutes an agreement to arbitrate disputes on an individual basis. Any party may bring an individual action in small claims court instead of pursuing arbitration, so long as the action remains in that court. All disputes and claims arising out of or relating to the Website, Customer Service, or any Report, except for those covered by Paragraph 20 above, must be resolved by binding arbitration. This agreement to arbitrate includes, but is not limited to, all disputes and claims between Company, transferor(s) and transferee(s) and claims that arose prior to purchase of the Report, but it excludes disputes and claims covered by Paragraph 20 above. This agreement to arbitrate applies to transferor(s) and transferee(s) successors in interest, assigns, heirs, spouses, and children. As noted above, a party may elect to bring an individual action in small claims court instead of arbitration, so long as the dispute falls within the jurisdictional requirements of small claims court.
- Any arbitration must take place on an individual basis. Company, transferor(s) and transferee(s) agree that they are waiving any right to a jury trial and to bring or participate in a class, representative, or private attorney general action, and further agree that the arbitrator lacks the power to grant relief affecting anyone other than the individual claimant. If a court decides that any of the provisions of this paragraph are invalid or unenforceable as to a particular claim or request for a particular remedy (such as a request for public injunctive relief), then that claim or request for that remedy must be brought in court and all other claims and requests for remedies must be arbitrated in accordance with this agreement.
- The arbitration is governed by the Consumer Arbitration Rules (the "AAA Rules") of the American Arbitration Association ("AAA"), as modified by this Agreement, and will be administered by the AAA. Company will pay all AAA filing, administration and arbitrator fees for any arbitration it initiates and for any arbitration initiated by another party for which the value of the claims is \$75,000 or less, unless an arbitrator determines that the claims have been brought in bad faith or for an improper purpose, in which case the payment of AAA fees will be governed by the AAA Rules #A COPY OF THESE RULES IS AVAILABLE FROM THE AAA'S WEB SITE AT [WWW.ADR.ORG](http://WWW.ADR.ORG) OR ON REQUEST FROM THE COMPANY. THE ARBITRATION AWARD MAY INCLUDE ATTORNEY'S FEES IF ALLOWED BY FEDERAL, STATE, OR OTHER APPLICABLE LAW AND MAY BE ENTERED AS A JUDGMENT IN ANY COURT OF PROPER JURISDICTION.
- The arbitration will take place in the same county in which the property covered by the Report is located. The Federal Arbitration Act will govern the interpretation, applicability and enforcement of this arbitration agreement. This arbitration agreement will survive the termination of the Report.
- 24) **Term; Termination.** The application of these Terms and Conditions will commence upon User's acceptance of the provisions of these Terms and Conditions by clicking "I Accept," calling Customer Service, or in any way accessing any Report or portion thereof and shall continue in perpetuity, unless sooner terminated pursuant to the terms hereof (the "Term"). Notwithstanding the foregoing, upon written notice to User, the Company may immediately terminate these Terms and Conditions, and terminate User's access to and use of the Website, Customer Service, and all Reports, for any reason at any time.
- 25) **Notices.** Any notice or other communication required or permitted under these Terms and Conditions shall be sufficiently given if delivered in person or sent by one of the following methods:
- Registered U.S. mail, return receipt requested (postage prepaid);
  - Certified U.S. mail, return receipt requested (postage prepaid); or
  - Commercially recognized overnight service with tracking capabilities.
- Notices to the Company shall be sent to 4 First American Way, Santa Ana, California 92707, with a copy to the Company's counsel at the same address marked Attention: Legal Department. Notices to User shall be sent to the address entered by User in the Website. Notices or communications shall be deemed properly delivered as of the date personally delivered or sent by mail or overnight service.
- 26) **Severability.** Except as otherwise provided above, if any provision of these Terms and Conditions is determined to be invalid or unenforceable for any reason, then such provision shall be treated as severed from the remainder of the Terms and Conditions, and shall not affect the validity and enforceability of all of the other provisions of the Terms and Conditions.
- 27) **Other Agreements.** These Terms and Conditions constitute the entire, integrated agreement between Company and any User using, possessing, or accessing the Website and/or Report, and supersede and replace all prior statements, representations, negotiations, and agreements.

**END OF REPORT**